

A127/A132 Nevendon Interchange Improvements Christopher Martin Road

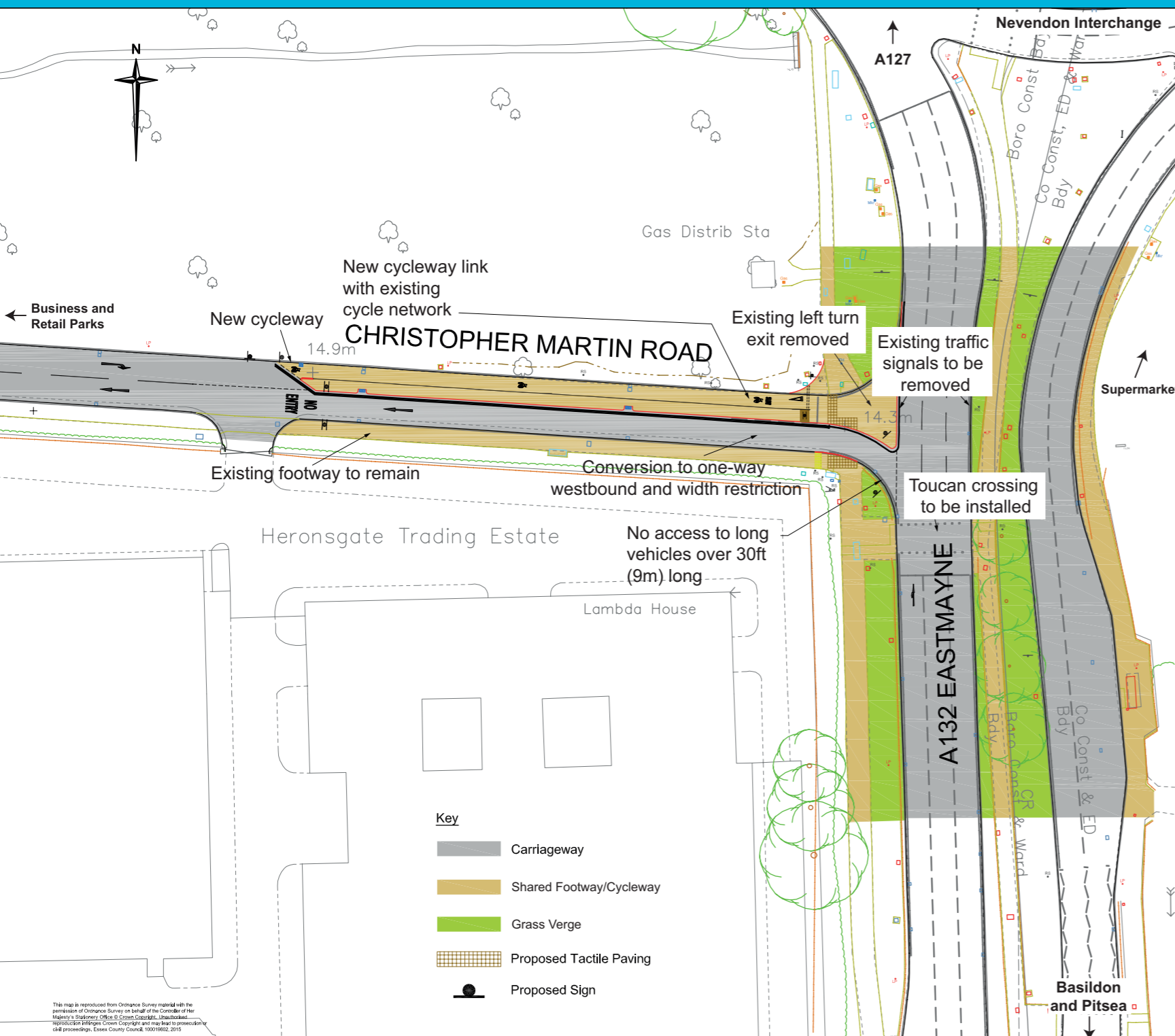

Overview of the Scheme

Improvements at the junction of Christopher Martin Road and A132 East Mayne are part of a larger scheme incorporating the main Nevendon Roundabout. The overall aim of the larger scheme is to improve journey times and manage traffic congestion at the A127 / A132 Nevendon Interchange.

Currently traffic exiting Christopher Martin Road blocks the junction and delays northbound traffic towards the roundabout. In this first phase it is proposed to remove the traffic signals at this junction and introduce a one-way road westbound on Christopher Martin Road for a distance of 269ft, enabling the main strategic road network to flow better.

Traffic currently exiting Christopher Martin Road will be redirected to the A132 East Mayne via Paycocke Road. A vehicle length restriction will be introduced at the junction of the A132 East Mayne and Christopher Martin Road. Long Vehicle access to the Business Park and Christopher Martin Road will be via Paycocke Road. Signing across the area will be amended to ensure Heavy Goods Vehicles and long vehicles are directed along Paycocke Road.

The pedestrian/cycle crossing facility incorporated in the current traffic signals will be replaced with a Toucan Crossing on East Mayne.

A cycleway will be introduced on the north-eastern end of Christopher Martin Road adjacent to the one-way section to enable cyclists to continue to access the cycle network on the A132.

Comments are welcome, there will also be a statutory consultation period which will be advertised on-site and in the local press in the coming weeks.

By telephone:
0345 603 7631

By email:
contact@essex.gov.uk

By post: Essex County Council Transport Strategy and Engagement Team
Economic Growth and Development
County Hall, Market Road
Chelmsford, Essex, CM1 1QH

Further information is available at:
www.essex.gov.uk/majorschemes