

DATED: *9th August*

2018

HIGHWAYS ENGLAND COMPANY LIMITED
HIGHWAYS ACT 1980

The M11 Harlow North Junction (7A) (Slip Roads,
Special Roads) Scheme 2018

THE HIGHWAYS ENGLAND COMPANY LIMITED
M11 HARLOW NORTH JUNCTION (7A) (SLIP ROADS, SPECIAL ROADS) SCHEME 2018



Track

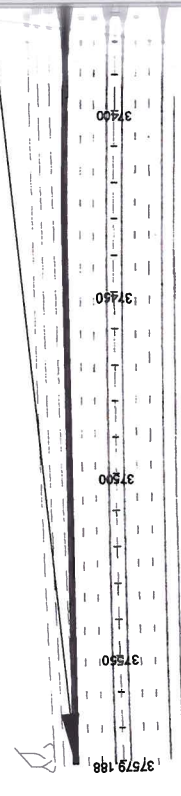

Co Const Bdy

Issues

Drain

Pincey Brook

CS

Ward Bdy
CR
FB



The map is based on Ordnance Survey material with the permission of Ordnance Survey on behalf of the Controller of Her Majesty's Stationery Office © Crown Copyright. Unauthorised reproduction infringes Crown Copyright and may lead to prosecution or civil proceedings. Highways England 1000030649, 2016

KEY:

Routes of the Special Roads



SCALE:



Signed on behalf of
Highways England Company Limited

Divisional Director
Highways England Company Limited

B3553705-0000-DR-1183



The map is based on Ordnance Survey material with the permission of Ordnance Survey on behalf of the Controller of Her Majesty's Stationery Office © Crown Copyright. Unauthorised reproduction infringes Crown Copyright and may lead to prosecution or civil proceedings. Highways England 1000030649, 2016

Routes of the Special Roads

0 50 100
SCALE 1 : 2000 @ A3 (metres)

Divisional Director
Highways England Company Limited

B3553F05-0000-DR-1182

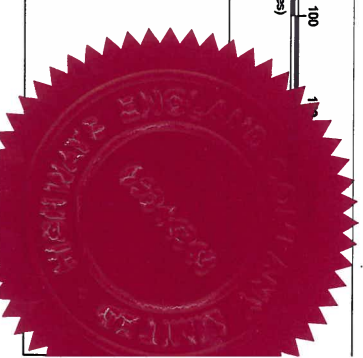

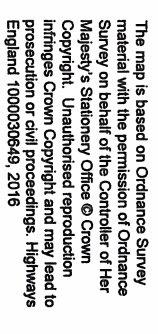

Routes of the Special Roads

0 50 100 150
SCALE 1 : 2000 @ A3 (metres)

Divisional Director
Highways England Company Limited

B3553F05-0000-DR-1181



THE HIGHWAYS ENGLAND COMPANY LIMITED
M11 HARLOW NORTH JUNCTION (7A) (SLIP ROADS, SPECIAL ROADS) SCHEME 2018

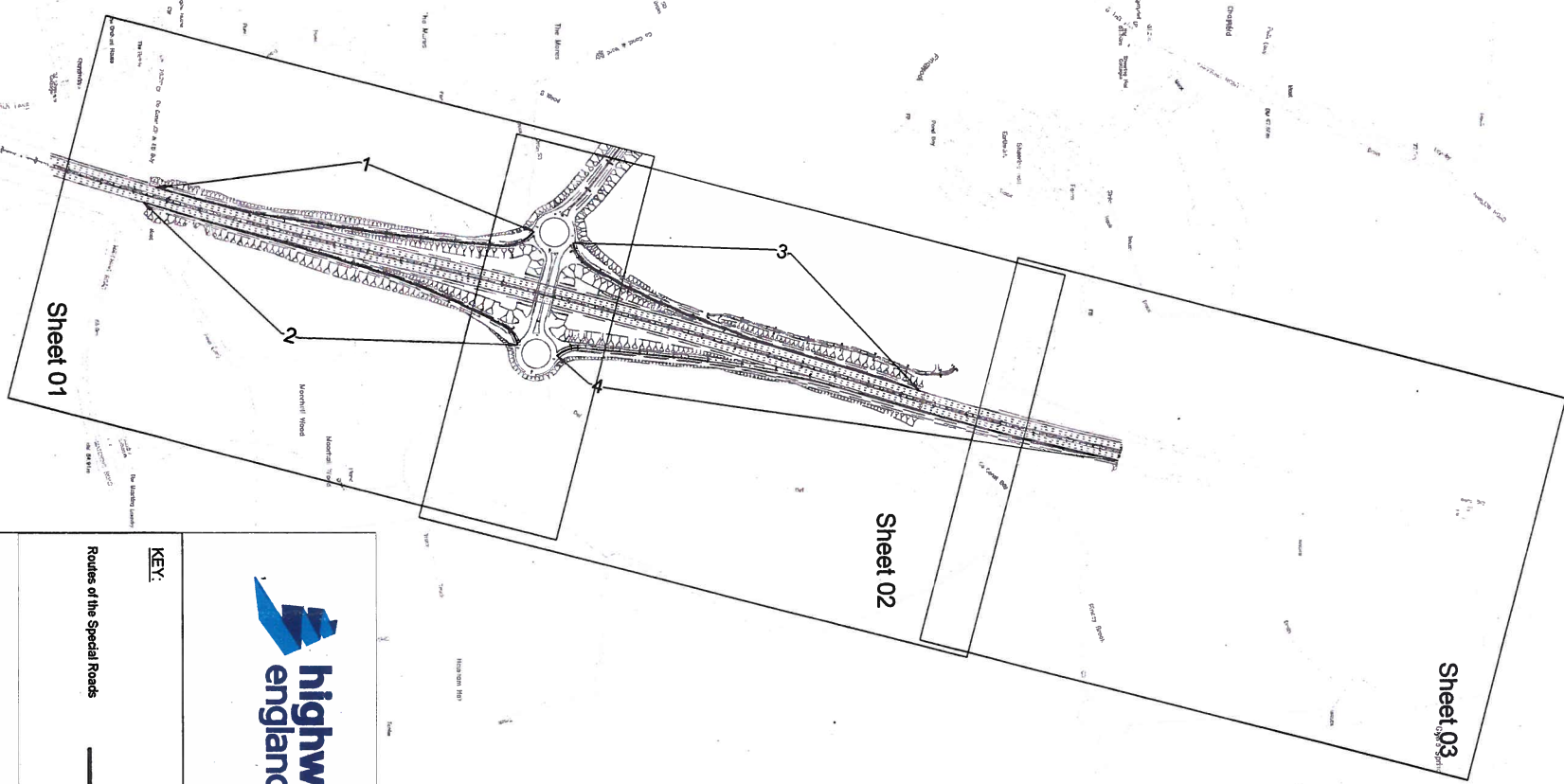

The map is based on Ordnance Survey material with the permission of Ordnance Survey on behalf of the Controller of Her Majesty's Stationery Office © Crown Copyright. Unauthorised reproduction infringes Crown Copyright and may lead to prosecution or civil proceedings. Highways England 1000030649, 2016

KEY:

Routes of the Special Roads

SCALE:

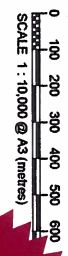

Signed on behalf of
Highways England Company Limited

Divisional Director
Highways England Company Limited

B3563F05-0000-DR-1180
How low 7/18

22/18
16/09/16

DEPOSITED PLAN REFERRED TO IN THE HIGHWAYS ENGLAND
COMPANY LIMITED M11 HARLOW NORTH JUNCTION (7A) (SLIP ROADS,
SPECIAL ROADS) SCHEME 2018 DATED: 9th August 2018

HIGHWAYS ACT 1980 SECTION 16

Signed on behalf of

Highways England Company Limited

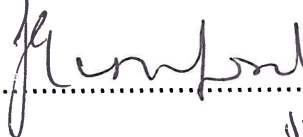
.....
JULIE CARSON

Divisional Director

Highways England Company Limited

9/82018



2018
No 9/6