

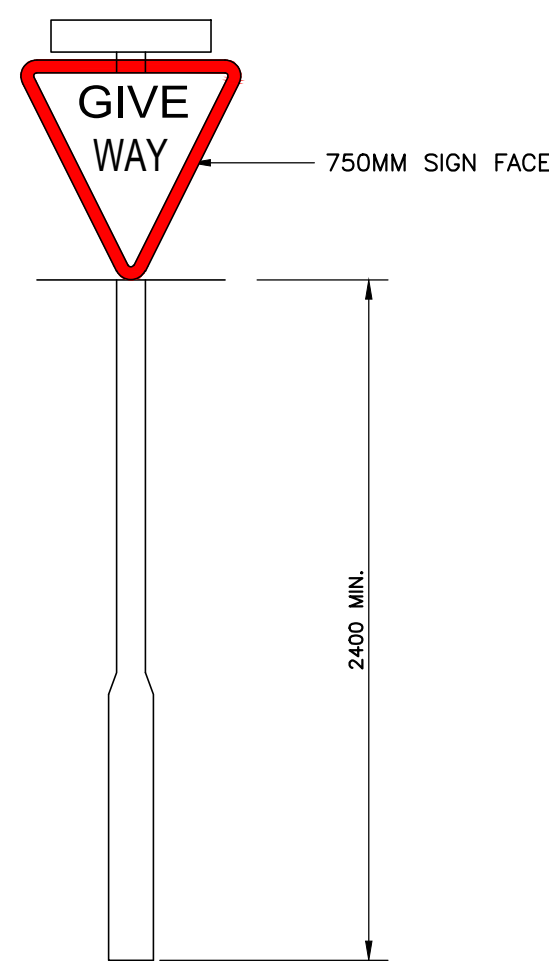

TRAFFIC SIGN DETAILS				sign No: 602			
SITE KIRBY CROSS				JOB No		LHE132	
TSRD REF:	602	ILLUMINATED	YES	✓	TYPE OF LANTERN	11 WATT (EXTERNAL)	
			NO				
POST DIA.	89mm L/B	POST LENGTH	4250		MOUNTING HEIGHT	2400	
FOUNDATION DEPTH	600	FOUNDATION WIDTH	LENGTH/ 600				
SIGN FACE SIZE		750	CLASS		RA2		



NOTES: SIGNS TO BE ILLUMINATED TO SCHEDULE 17 OR THE TSRGD
ALL DIMENSIONS ARE MILLIMETRES.
SIGNS TO BE MOUNTED AND INSTALLED IN ACCORDANCE WITH
E.C.C. SPECIFICATIONS

TRAFFIC SIGN DETAILS				sign No: 543			
SITE KIRBY CROSS				JOB No		LHE132	
TSD REF:	543	ILLUMINATED	YES No <input checked="" type="checkbox"/>	TYPE OF LANTERN		11 WATT (EXTERNAL)	
POST DIA.	89mm L/B	POST LENGTH	4250	MOUNTING HEIGHT		2400	
FOUNDATION DEPTH	600	FOUNDATION LENGTH/ WIDTH	600				
SIGN FACE SIZE	750mm		CLASS	RA2			

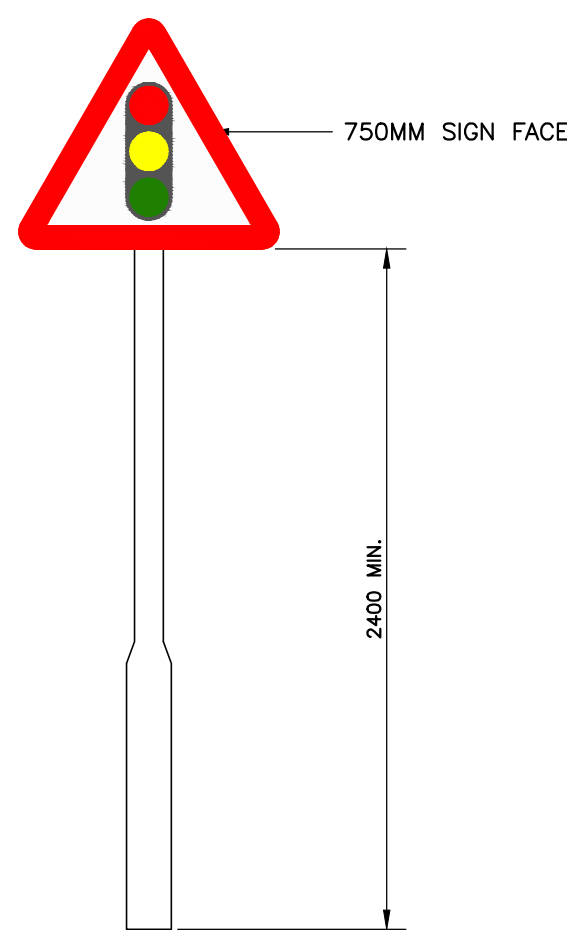

NOTES:
ALL DIMENSIONS ARE MILLIMETRES.
SIGNS TO BE MOUNTED AND INSTALLED IN ACCORDANCE WITH
E.C.C. SPECIFICATIONS

TRAFFIC SIGN DETAILS				sign No: 544			
SITE KIRBY CROSS				JOB No		LHE132	
TSRD REF: 544		ILLUMINATED YES NO <input checked="" type="checkbox"/>		TYPE OF LANTERN		11 WATT (EXTERNAL)	
FOUN DIA. 89mm L/B		POST LENGTH 4250		MOUNTING HEIGHT		2400	
FOUNDATION DEPTH 600		FOUNDATION LENGTH/ WIDTH		600			
SIGN FACE SIZE 750mm		CLASS RA2					

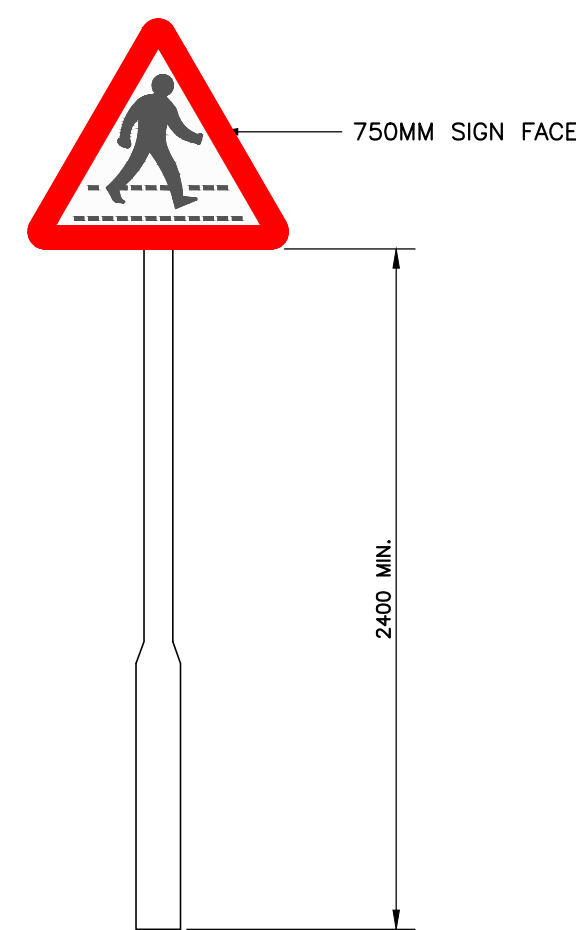

NOTES:
ALL DIMENSIONS ARE MILLIMETRES.
SIGNS TO BE MOUNTED AND INSTALLED IN ACCORDANCE WITH
E.C.C. SPECIFICATIONS

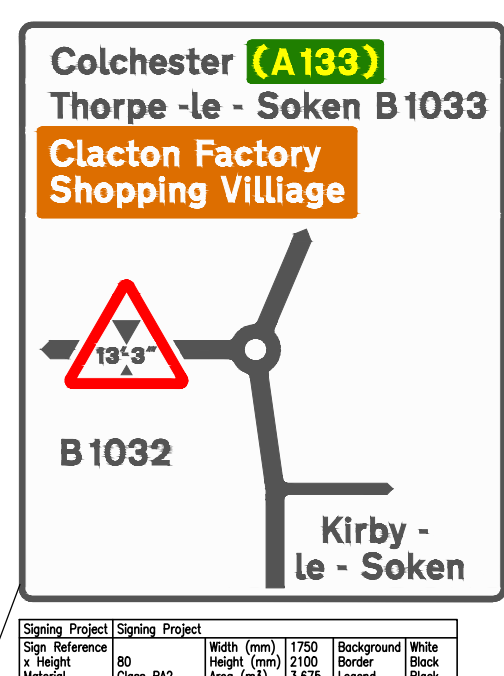
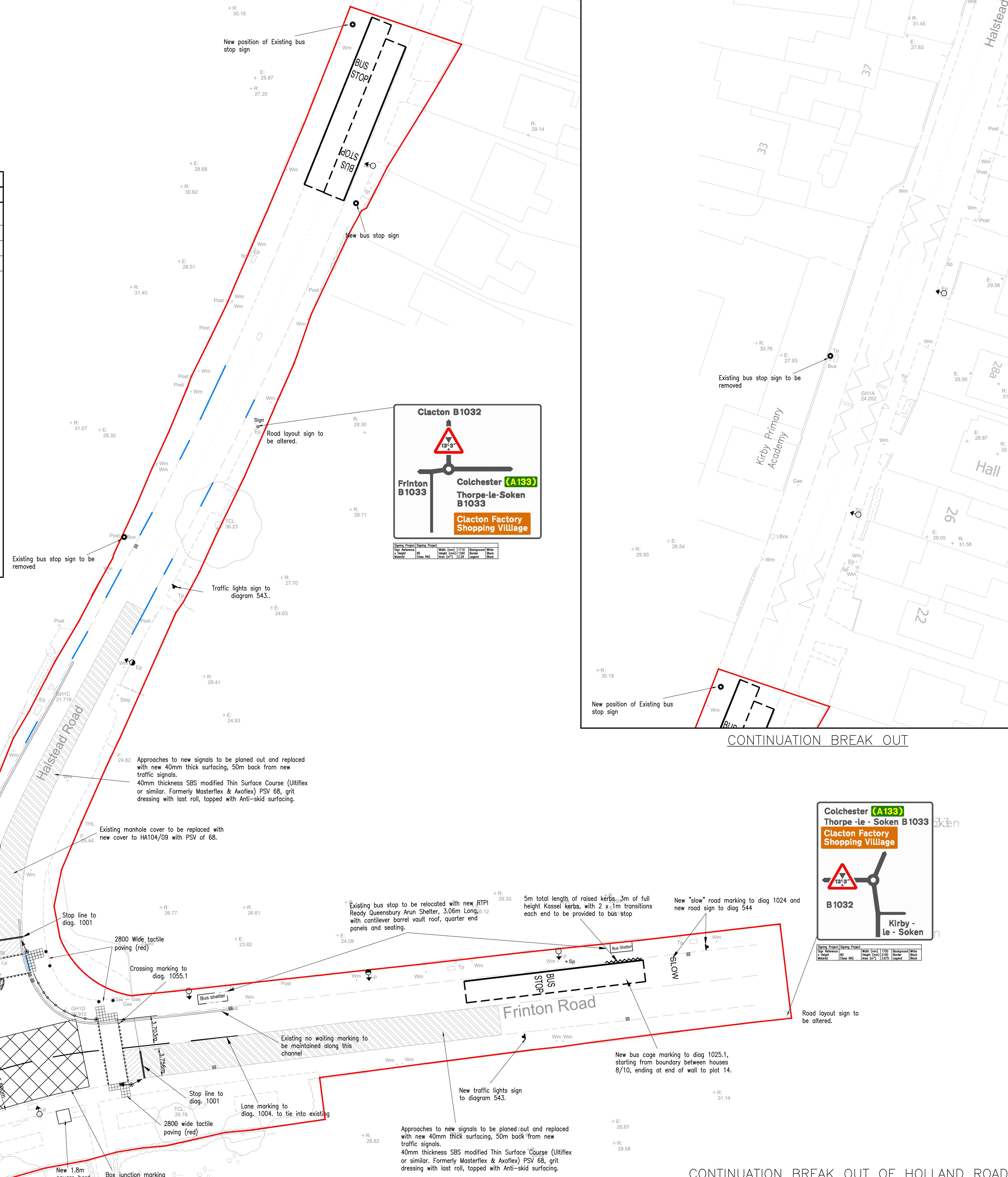
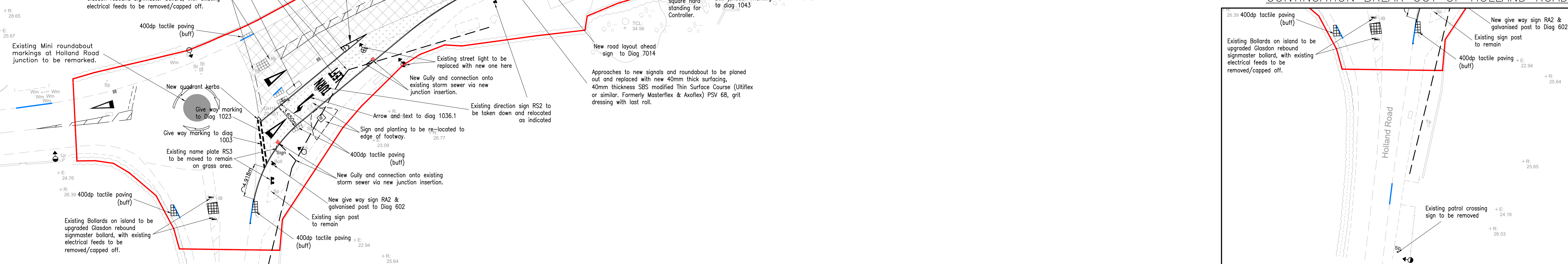
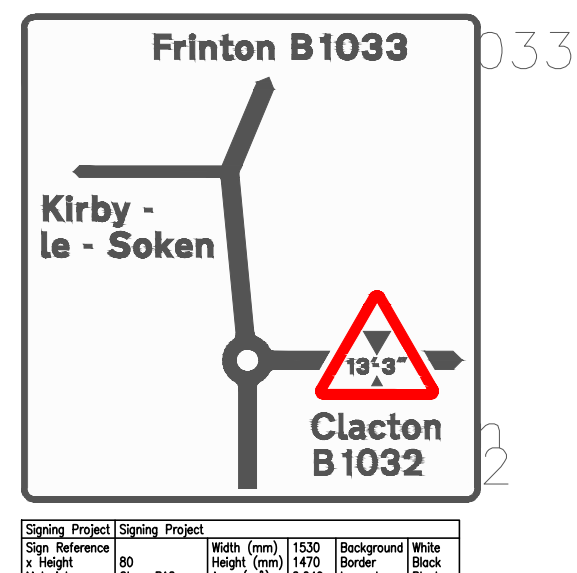
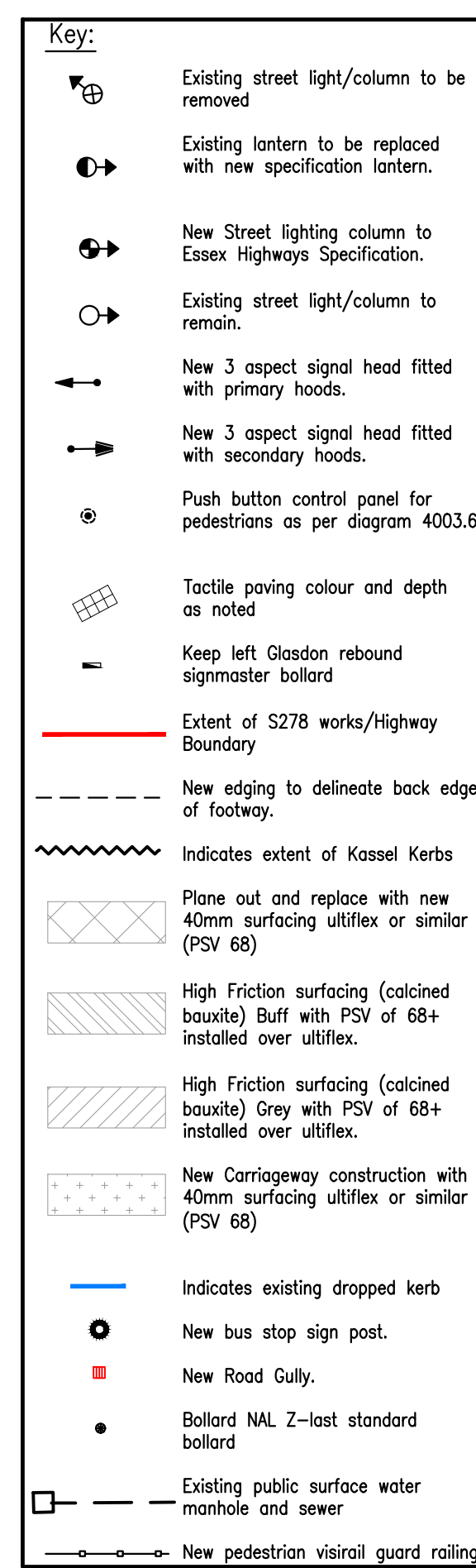

CONTINUATION BREAK OUT

CONTINUATION BREAK OUT OF HOLLAND ROAD

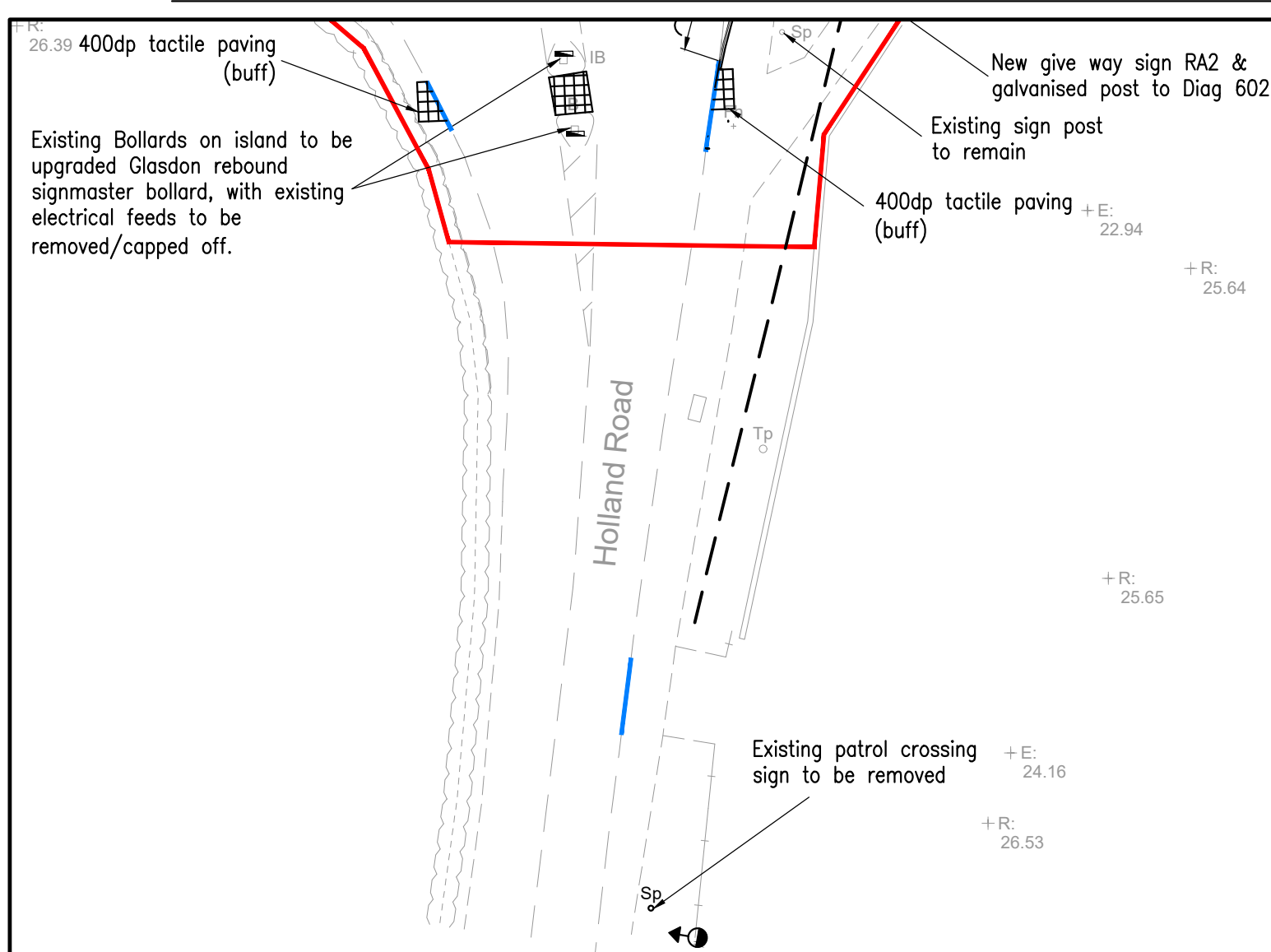

- Notes:**
1. For construction works details refer to drawing number LHE132/1018
 2. For pavement construction details refer to drawing No. LHE132/1014-1016
 3. All works to comply fully with Essex County Council Development Construction Manual 2016.
 4. All signs and marking to be in accordance with the TSRGD 2016.
 5. For mechanical and electrical works details and specifications in relation to the installation of the signal heads refer to specialist designers drawings
 6. All existing street lighting to be maintained unless noted.
 7. All existing road markings within the works boundary to be renewed
 8. For lighting design drawings, please refer to Ringway Jacobs drawing ECC-17-555-4-1300-001.
 9. Existing Mini roundabout markings at Holland Road junction to be remarked.
 10. A minimum 1.5m footway clearance to be achieved at each signal pole location by the provision of a 100mm widening where necessary.
 11. Traffic signal poles shall be located such that the minimum horizontal clearance between the traffic signal head, including back board, and the edge of carriageway is 0.45 metres.
 12. New bus shelter along Frinton Road to be RTPI Ready
 13. Existing/remaining road markings within extent of section 276 works to be re-freshed/painted.

16/8/2021	New pedestrian Vialant guard rolling re-installed.	AB	LW	
U	20/03/2020	Sign face sizes enlarged to match on site.	AB	LW
T	12/03/2020	Car sign sign text changed to "No U-turns". Right hand changed back to being "summitted".	AB	LW
S	24/02/2020	Top signification in 'h' adjusted as per requested.	AB	LW
R	10/02/2020	Street lighting updated to latest standards. All other various changes as per highways request.	AB	LW
Q	14/01/2020	Drawing adjusted to show entire width of crossing. New highway boundary red line.	AB	LW
P	20/12/2019	New road gullies now connecting to existing sewerage. New drainage insertion, as requested by Anglian Water.	AB	LW
N	10/12/2019	Transferred various existing signs to new road. New drawing L1H32/1081 in order to comply with drawing. All changes as per meeting with highways.	AB	LW
M	06/11/2019	Specification of new bus shelter along Frinton Road upgraded to be "BTR" ready.	AB	LW
L	11/10/2019	Alignment of giveway Mark to be "BTR" ready. Highway boundary red line. Highway crossing adjusted.	AB	LW
K	22/08/2019	"No" option on surfacing speed removed, as per highways request. 400 deep lettering added to existing Holland crossing. Pedestrian crossing sign.	AB	LW
J	17/07/2019	Anti-slip description in key modified. Symbol for keep left turn line updated. New left hand turn line separated and re-signaged.	AB	LW
H	08/07/2019	Minor adjustments as to latest highway comments. Highway crossing adjustments as clouded.	AB	LW
G	17/06/2019	Adjustments as to latest highways comments. Highway crossing adjustments as clouded.	AB	LW
F	29/06/2018	Left hand turning lane. New design for "No U-turns" request. Sign references changed to additional traffic signs. Highway request. PSV reverted back to 68.	AB	LW
E	24/04/2018	Drawing updated as per highways request, including additional ASDE crossing. Proposed Traffic paving removed from Holland crossing. Drawing enlarged to AD sheet.	AB	LW
D	12/03/2018	Bus gauge and shelter specification updated to specification confirmed by Passenger Transport Licensing. Hatched road junction updated to match approved traffic signs.	AB	LW
C	09/02/2018	Numerous changes in line with highway request. Various signs removed, with traffic signs altered as per request.	AB	LW
B	03/01/2018	Pedestrian crossings changed to include 3'x3' push button control panel. Pedestrians as per request. 4003.6. Signal heads moved, and additional traffic control introduced as per highways request.	AB	LW
A	19/12/2017	Road marking and signs updated. Frinton Road crossing adjusted. Hatched Street lighting signs adjusted to match Ringway Deep.	LW	AB

STATUS	FOR APPROVAL
--------	--------------

Kirby Cross
Essex

CLIENT



Frinton Road
Junction Works
General Arrangement
Plan

DATE 7.12.17	DRAWN BY AD
SCALES (10A0)-1:250	CHECKED BY LEW

DRG LHE132/1017^V
NO.

walker*associates*
CONSULTING LIMITED

Address 13 Capricorn Centre
Granes Farm Road
Basildon
Essex SS14 3JJ

Tel 01268 530 500

Fax 01268 28 66 28

Web www.walker-associates.co.uk