

NO PARKING CONES TO BE PLACED DOWN POST OFFICE ROAD

BUS STOPS 1 & 2 TO BE SUSPENDED

2X BANKSMAN TO BE LOCATED HERE TO ASSIST BUS'S TURNING

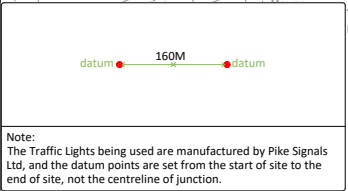

STAGE DIAGRAM			
1	2	3	4
→	←	←	→

SIGNAL TIMINGS	
MAX GREEN 50	MAX GREEN 50

ALL RED MATRIX			
	1	2	
1	20		
2	20		

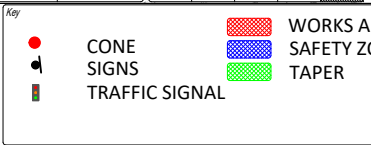

- Notes
- All dimensions are in metres unless otherwise stated.
 - All traffic management to comply with Chapter 8 and any updates, and Safety at Street Works and Road Works (A Code of Practice)
 - All road markings and signs to be as per the Traffic Signs Regulations and General Directions 2002.
 - All permanent traffic signals will be bagged and switched out, at all times that temporary traffic signals are being used. This should be done with approval from said authority.
 - A minimum clearance of 1.5m (absolute minimum 1.0m) to be maintained for pedestrians on footways. If this cannot be maintained signs to be placed in the c/way with associated coning.
 - Additional Road Works ahead to be used where appropriate.

marlborough
we understand, we deliver

Woolf House, 7 Eagle Way
Regiment Business Park
Essex Regiment Way
Chelmsford
CM3 3FY

Client **Essex Highways**

Location **TERMINUS STREET - HARLOW - CM20 1JH**

Work Details **PHASE 1 & 2**

Description	Rev.	Date	By
Original Issue for Comments	P1	02/07/20	WC
Revisions	P2		
	P3		
	P4		
	P5		
	P6		
	P7		

Date	Designer
JULY 2020	WC
Scale(s) @ Original Size A3	Checked Approved
NOT TO SCALE	NZ NZ
Drawing Number	Revision
10554.007	P1

Ordnance Survey © Crown Copyright 2012. All rights reserved. Licence Number 100020449