

INSET A  
SCALE 1:250



AREA OF INTEREST  
SCALE 1:2500

General Construction Notes

1. Do not scale. This drawing is to be read in conjunction with all other contract drawings and documents.
2. All works to be in accordance with the Department of Transport's Specification for Highway Works and Essex County Council Specifications and Standard Construction Drawings.
3. Drawing to be read in conjunction with E08-020B-023-1100-02

Key

- Area of interest
- Take up and remove off site to tip existing block paving and remove off site to tip. Excavate as plan to average depth of 140mm - Area 1208m<sup>2</sup>
- Excavate area to average depth of 200mm max - Area 145m<sup>2</sup>
- Take up and remove off site to tip existing paving slabs. Excavate as plan to average depth of 140mm - Area 302m<sup>2</sup>
- Take up and remove off site to tip existing tactile paving slabs. Excavate as plan to average depth of 140mm - Area 17m<sup>2</sup>
- Excavate area to except proposed flat top edging and backing 250mm x required depth - Length 85m
- Take up and remove off site to tip existing chamfered edged blocks and backing - Length 60m
- Take up and set aside for reuse existing granite kerbing - Length 37m
- Take up and remove off site to tip flat top edging and backing - Length 66m
- Take up and remove off site to tip kerbing, bedding and backing - Length 35m
- Take up and remove off site to tip existing Kaslie kerbs - Length 11.5m
- Existing square bollards to be taken up and removed off site to tip - N° 28
- Existing damaged wide Based post to be taken up and removed off site to tip - power supply to be disconnected by Distribution Network Operator (DNO) and made safe
- Existing mini pillar to be removed off site to tip power supply to be disconnected by Distribution Network Operator (DNO) and made safe
- Take up and remove off site to tip existing pedestrian guard rail - Length 29m
- S773 & S774 Take up and remove of site to tip Halo bollards. Lamp bases to remain - N°2
- Existing bus shelter to be removed by others
- Existing kerbing to remain
- Existing guard rail to remain
- Existing covers to remain
- Existing bollards to remain - N°25
- Proposed revised works areas

Rev	Date	Description of revision	Drawn	Checked	Reviewed	Approved
A	17/04/20	Bollards on northern side of road now to remain, additional kerb removal along Rectory Rd	MPM	SM	SM	SM

DRAWING STATUS

**DETAILED DESIGN**

Essex Highways, Seax House, Victoria Road South, Chelmsford, CM1 1QH.  
Tel: 0345 6037631 © Essex County Council

SCHEME TITLE  
**HADLEIGH PUBLIC REALM IMPROVEMENTS  
E08-020B-023  
SS7 2RD**

DRAWING TITLE  
**SITE CLEARANCE**

DESIGNED	DRAWN	CHECKED	REVIEWED	APPROVED
MPM	MPM	BSE	JO	JO
DATE OCT 19	DATE OCT 19	DATE OCT 19	DATE OCT 19	DATE OCT 19

DRAWING UNITS U.I.D.  
DIMENSIONS IN METRES  
LEVELS IN MILLIMETRES

SCALE AT A1 (841x594mm)  
AS SHOWN

DRAWING No. **E08-020B-023-200-02** REV. **A**

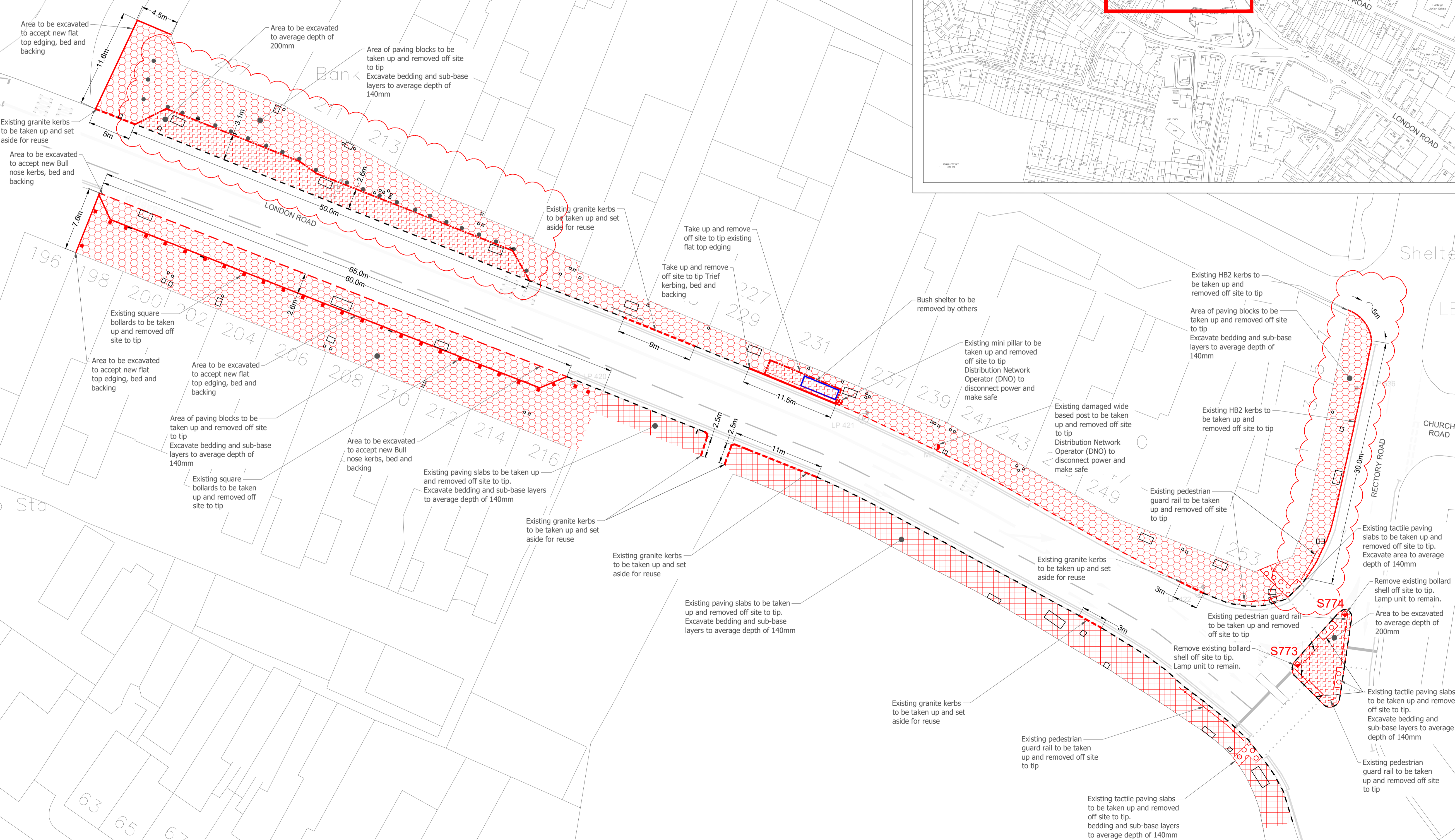

This map is reproduced from Ordnance Survey material with the permission of Ordnance Survey on behalf of the Controller of Her Majesty's Stationery Office © Crown Copyright. Unauthorised reproduction infringes Crown Copyright and may lead to prosecution or civil proceedings. Essex County Council, 100019602-2019  
File Location N:\9 Trans\Imp\DC\Projects\DC Scheme Files 2019\20\E08-020B-023 - Hadleigh Town Centre - Public Realm\3 - Drawing Records\E08-020B-023 - Hadleigh Town Centre - Drawings.dwg Last saved by Matthew Mills on 14 May 2020 Printed By Matthew Mills on 14 May 2020