

INSET A
SCALE 1:250

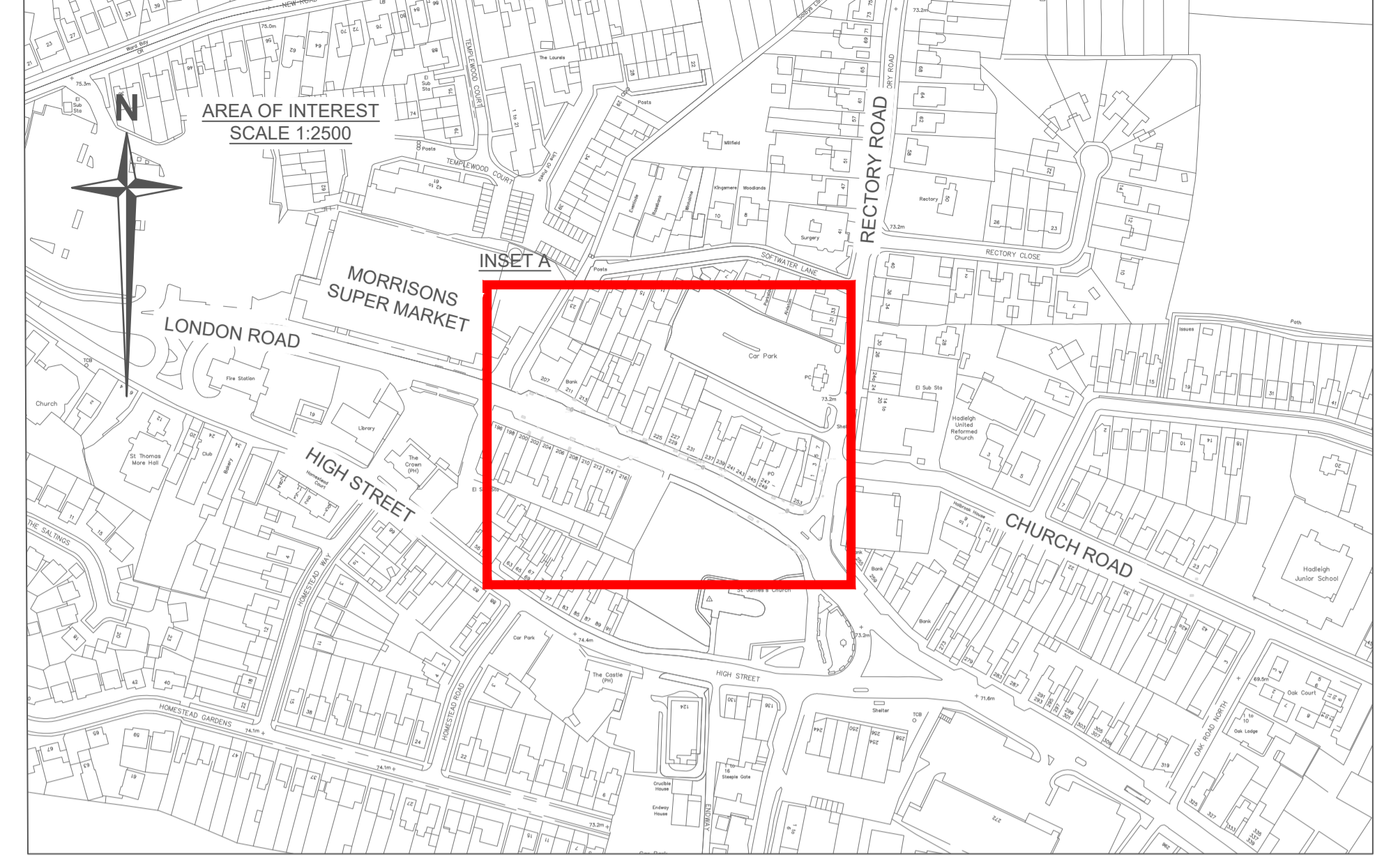

- General Construction Notes
- Do not scale. This drawing is to be read in conjunction with all other contract drawings and documents.
 - All works to be in accordance with the Department of Transport Specification for Highway Works and Essex County Council Specifications and Standard Construction Drawings.
 - Drawing to be read in conjunction with E08-020B-023-200-02
- Key
- Area of interest
 - Proposed 600mm x 450mm x 63mm Appalachian concrete paving slabs laid on 30mm of sharp sand and 120mm CBGM-C sub-base to clause 823 - Area 1060m²
 - Proposed construction to be: 20mm 0/06 DAC Surface Course as per clause 909 60mm 0/20 DAC Binder Course as per clause 929 120mm CBGM-C Sub Base as per clause 823 - Area 613m²
 - Proposed cast iron Manchester Bollards (colour RAL 9005) Bollards to be installed at 1500mm centres unless otherwise indicated - N° 47
 - Existing bollards to be rubbed down, undercoated and painted black (RAL colour 9005) - N°25
 - Proposed flat top edging (refer to detail) - Length 138m
 - Proposed bull nose kerbs (refer to detail) - Length 62m
 - Proposed HB2 kerbs (refer to detail) - Length 33m
 - Proposed HB2 transition kerbs - Length 1.8m
 - Granite kerb to re-laid. Kerb heights to match existing kerb heights - Length 36m
 - Proposed granite kerbs - Length 11.5m (refer to detail)
 - Proposed Haldo (or similar) bollards (refer to detail) to be installed on existing lamp bases - N°2
 - Proposed areas of blister tactile paving (Red) to replace existing Slabs to be laid on 30mm of sharp sand and 120mm CBGM-C sub-base - Area 17m²
 - Existing covers to be adjusted to suit new levels
 - Existing lamp column to remain
 - Existing sign and post to remain
 - Existing kerbing to remain
 - Existing guard rail to remain
 - Proposed revised works areas

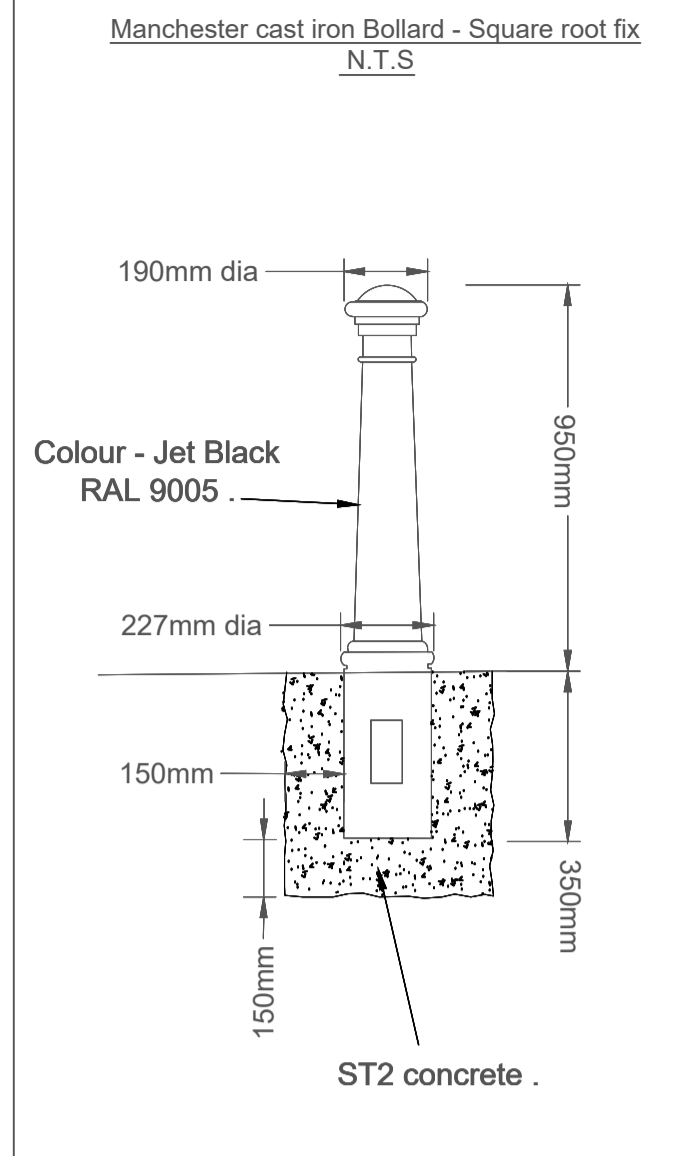
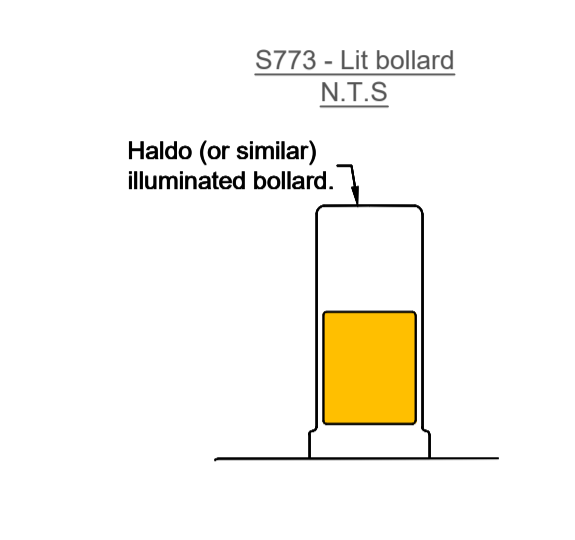
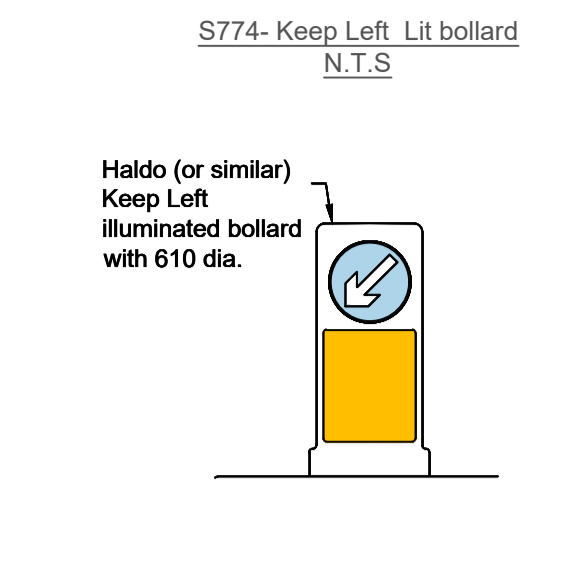
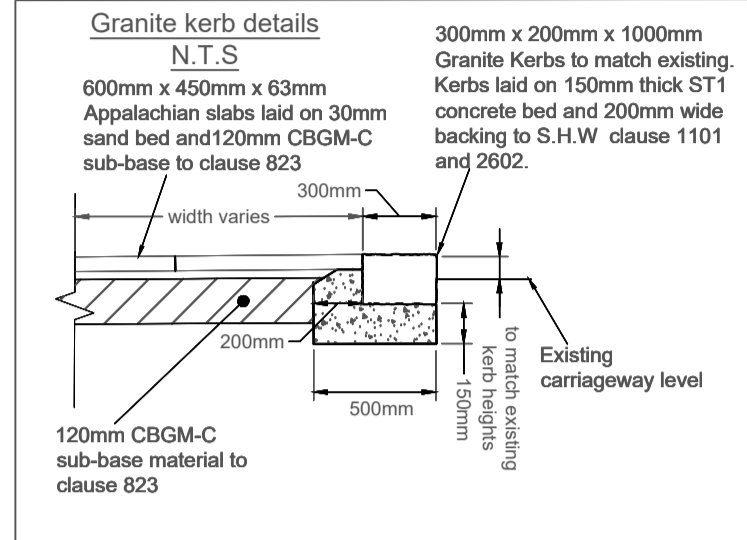
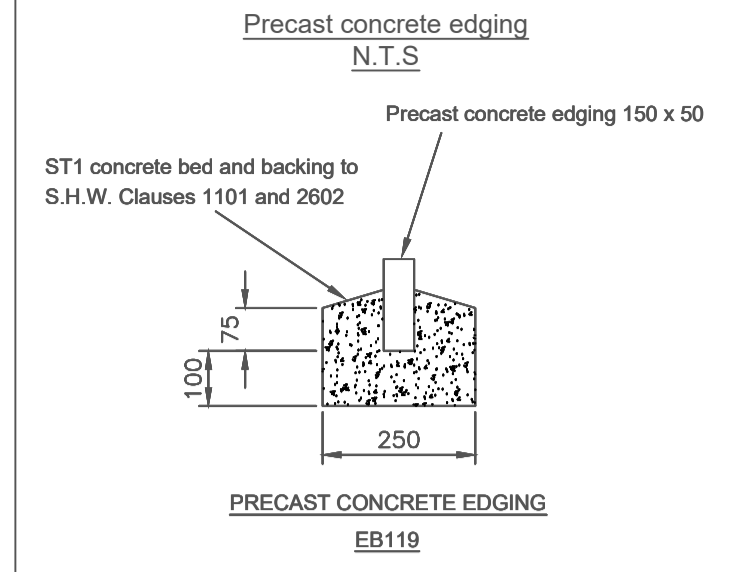
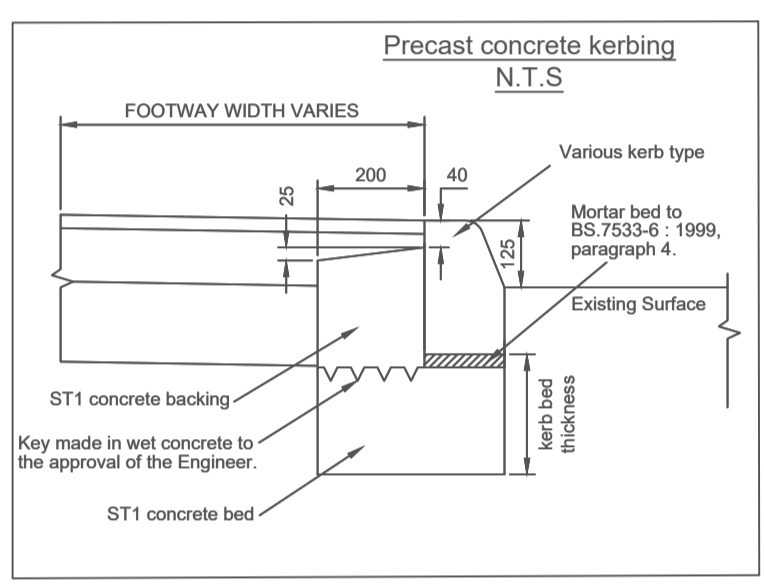
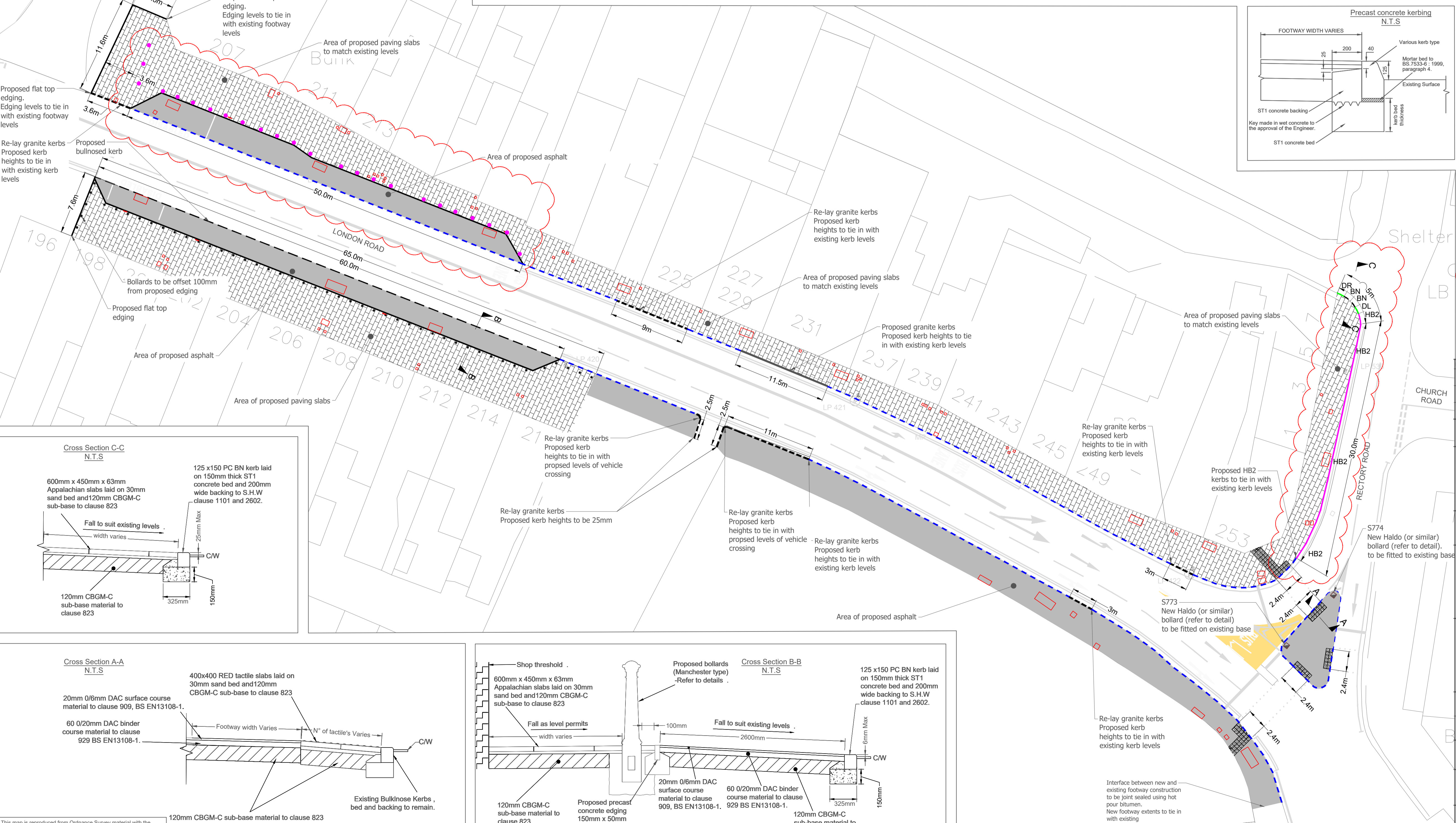

- Key
- Area of interest
 - Proposed 600mm x 450mm x 63mm Appalachian concrete paving slabs laid on 30mm of sharp sand and 120mm CBGM-C sub-base to clause 823 - Area 1060m²
 - Proposed construction to be: 20mm 0/06 DAC Surface Course as per clause 909 60mm 0/20 DAC Binder Course as per clause 929 120mm CBGM-C Sub Base as per clause 823 - Area 613m²
 - Proposed cast iron Manchester Bollards (colour RAL 9005) Bollards to be installed at 1500mm centres unless otherwise indicated - N° 47
 - Existing bollards to be rubbed down, undercoated and painted black (RAL colour 9005) - N°25
 - Proposed flat top edging (refer to detail) - Length 138m
 - Proposed bull nose kerbs (refer to detail) - Length 62m
 - Proposed HB2 kerbs (refer to detail) - Length 33m
 - Proposed HB2 transition kerbs - Length 1.8m
 - Granite kerb to re-laid. Kerb heights to match existing kerb heights - Length 36m
 - Proposed granite kerbs - Length 11.5m (refer to detail)
 - Proposed Haldo (or similar) bollards (refer to detail) to be installed on existing lamp bases - N°2
 - Proposed areas of blister tactile paving (Red) to replace existing Slabs to be laid on 30mm of sharp sand and 120mm CBGM-C sub-base - Area 17m²
 - Existing covers to be adjusted to suit new levels
 - Existing lamp column to remain
 - Existing sign and post to remain
 - Existing kerbing to remain
 - Existing guard rail to remain
 - Proposed revised works areas

Rev	Date	Description of revision	Drawn	Checked	Reviewed	Approved
A	17/04/20	Bollards on northern side of road row to be repainted, additional HB2 kerbing along Rectory Rd	MPM	SM	SM	SM

DRAWING STATUS

DETAILED DESIGN

Essex Highways, Seax House, Victoria Road South, Chelmsford, CM1 1QH.
Tel: 0345 6037631

© Essex County Council

SCHEME TITLE

HADLEIGH PUBLIC REALM IMPROVEMENTS E08-020B-023 SS7 2RD

DRAWING TITLE

GENERAL ARRANGEMENT

DESIGNED	DRAWN	CHECKED	REVIEWED	APPROVED
MPM	MPM	BSE	JO	JO
DATE OCT 19	DATE OCT 19	DATE OCT 19	DATE OCT 19	DATE OCT 19
DRAWING UNITS U.I.D. DIMENSIONS IN METRES LEVELS IN MILLIMETRES			SCALE AT A1 (841x594mm) AS SHOWN	
DRAWING No. E08-020B-023-1100-02				REV. A

This map is reproduced from Ordnance Survey material with the permission of Ordnance Survey on behalf of the Controller of Her Majesty's Stationery Office © Crown Copyright. Unauthorised reproduction infringes Crown Copyright and may lead to prosecution or civil proceedings. Essex County Council, 100019602, 2019

File Location N:\9 Trans Impr\DC\Projects\DC Scheme Files 2019-20\E08-020B-023 - Hadleigh Town Centre Public Realm\3 - Drawing Records\E08-020B-023 - Hadleigh Town Centre - Drawings.dwg Last saved by Matthew Mills on 14 May 2020 Printed By Matthew Mills on 14 May 2020