

ESSEX COUNTY COUNCIL

PUBLIC PATH EXTINGUISHMENT ORDER 2020

BRIDLEWAY 233 BASILDON

**IN
THE BOROUGH OF BASILDON**

HIGHWAYS ACT 1980 – SECTION 118

PUBLIC PATH EXTINGUISHMENT ORDER

PUBLIC PATH EXTINGUISHMENT ORDER
HIGHWAYS ACT 1980 – SECTION 118
ESSEX COUNTY COUNCIL
BRIDLEWAY 233 BASILDON

This Order is made by Essex County Council (“the authority”) under section 118 of the Highways Act 1980 (“the 1980 Act”) because it appears to the authority that part widths of the footpath described in paragraph 1 below are not needed for public use.

Basildon Borough Council have been consulted and have consented to the making of the order as required by section 120(2) of the 1980 Act.

BY THIS ORDER:

1) Part widths of the public right of way over the land situated at New House Farm known as Bridleway 233 Basildon in the Borough of Basildon and shown by a continuous bold line on the order map numbered PROW-20-21 rev.20.07.20 contained in this order and described in the Schedule to this order shall be extinguished after 14 days from the date of confirmation of this order

SCHEDULE

DESCRIPTION OF SITE OF EXISTING PATH OR WAY TO BE EXTINGUISHED

Part widths of part of the length of Bridleway 233 Basildon shown by a bold continuous line along with the widths to be extinguished shown hatched on the order map numbered PROW-20-21 rev.20.07.20 contained in this order commencing from point **A** at grid reference 56595,18737 on the access drive to the Essex Wildlife Trust visitor centre running in an east north easterly direction for a distance of approximately 10 metres along the access drive to point **B** at grid reference 56596,18737 where it continues in an east north easterly direction for a final distance of approximately 26 metres along the access drive to point **C** at grid reference 56599,18738 where it continues unaffected.

The various approximate widths of the existing path are defined as follows:

Point **A** to Point **B** 12 metres wide

Point **B** to Point **C** 12 metres wide

The various widths of the path to be extinguished and the various widths of the path to remain for public use are defined as follows:

	Grid Reference (southern edge of path)	To be extinguished (hatched)	To remain for public use (shaded grey)
Point A to Point B	56595,18737 56596,18737	9 metres	3 metres
Point B to Point C	56599,18738	6 metres	6 metres

Given under the Common Seal of Essex County Council this 14th day
of October 2020

The common seal of **ESSEX**)
COUNTY COUNCIL was here-)
unto affixed in the presence of:)



Attesting Officer: *[Signature]* 41218

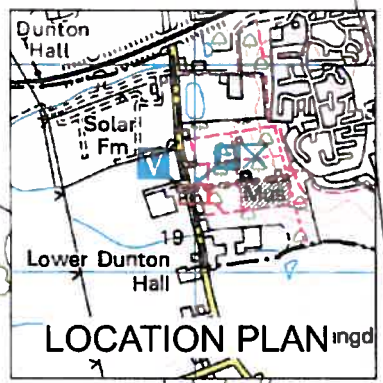
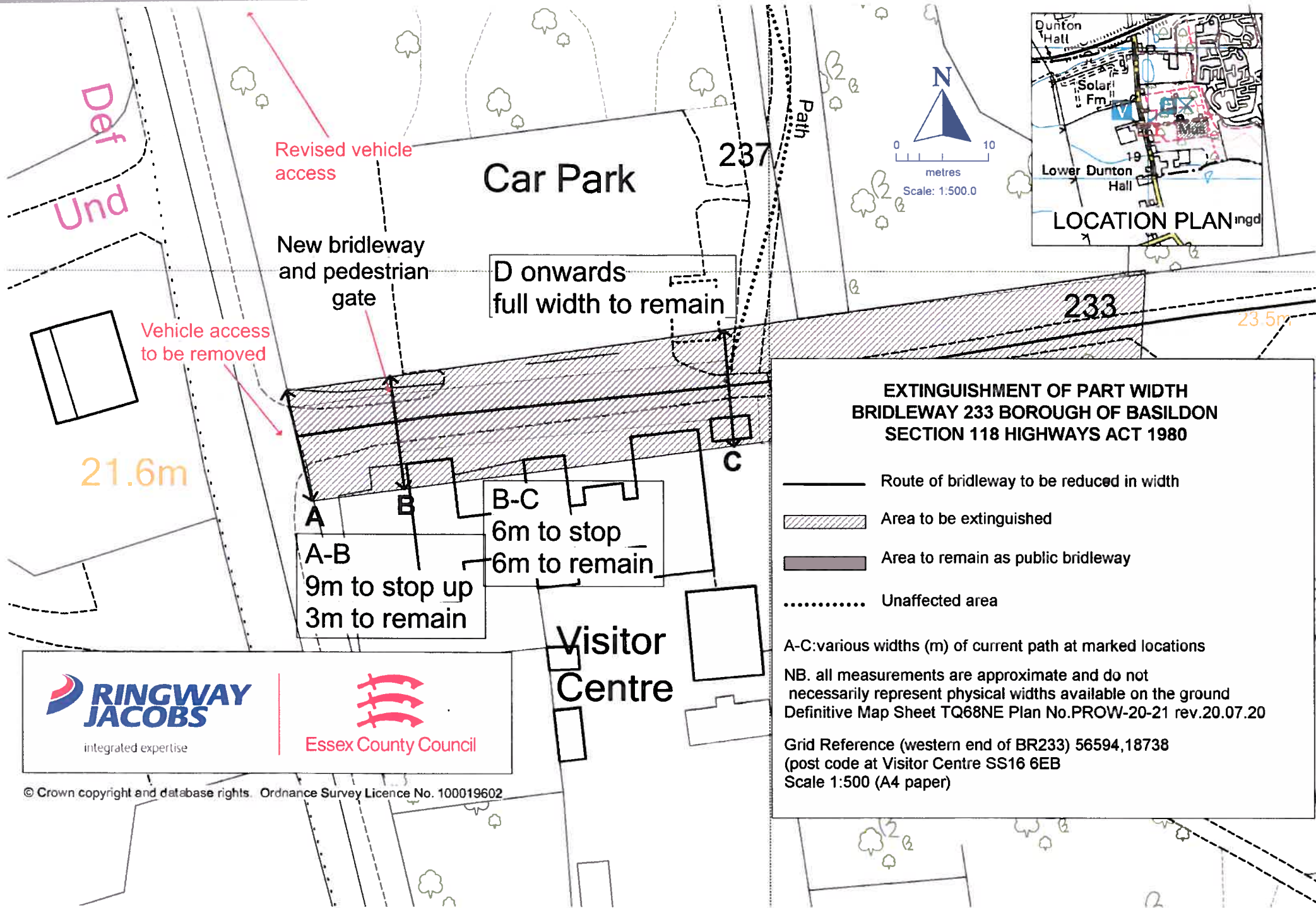

**EXTINGUISHMENT OF PART WIDTH
BRIDLEWAY 233 BOROUGH OF BASILDON
SECTION 118 HIGHWAYS ACT 1980**

- Route of bridleway to be reduced in width
- ▨ Area to be extinguished
- Area to remain as public bridleway
- Unaffected area

A-C: various widths (m) of current path at marked locations
 NB. all measurements are approximate and do not necessarily represent physical widths available on the ground
 Definitive Map Sheet TQ68NE Plan No. PROW-20-21 rev.20.07.20
 Grid Reference (western end of BR233) 56594,18738
 (post code at Visitor Centre SS16 6EB)
 Scale 1:500 (A4 paper)



integrated expertise



Essex County Council

© Crown copyright and database rights. Ordnance Survey Licence No. 100019602

Dated: 14th day of October 2020

**PUBLIC PATH EXTINGUISHMENT
ORDER**

HIGHWAYS ACT 1980 - SECTION 118

Bridleway 233 (part widths) in the Borough
of Basildon in the County of Essex

Paul Turner
Director, Legal and Assurance

Essex Legal Services
Seax House
Victoria Road South
Chelmsford
Essex
CM1 1QH