

ESSEX COUNTY COUNCIL

PUBLIC PATH DIVERSION ORDER 2023

FOOTPATH 22 WIDDINGTON

IN THE DISTRICT OF UTTLESFORD

HIGHWAYS ACT 1980 - SECTION 119

PUBLIC PATH DIVERSION ORDER

PUBLIC PATH DIVERSION ORDER
HIGHWAYS ACT 1980 – SECTION 119
ESSEX COUNTY COUNCIL
FOOTPATH 22 WIDDINGTON

This Order is made by Essex County Council (“the authority”) under section 119 of the Highways Act 1980 (“the 1980 Act”) because it appears to the authority that in the interest of the owner of the land crossed by the footpath described in paragraph 1 of this order it is expedient that the line of the path should be diverted.

The landowner has agreed to defray any compensation which becomes payable in consequence of the coming into force of this order and any expenses which are incurred in the order making and bringing the new site of the path into a fit condition for use by the public.

Uttlesford District Council have been consulted.

BY THIS ORDER:

- 1) The public right of way over land situated north east of Newlands Farm known as Footpath 22 Widdington in the District of Uttlesford and shown by a bold continuous line on the order map numbered PROW-22-24 contained in this order and described in Part 1 of the Schedule to this order shall be stopped up after 35 days from the date of confirmation of this order.
- 2) There shall at the end of 28 days from the date of confirmation of this order be a public footpath over land situated north east of Newlands Farm known as Footpath 22 Widdington in the District of Uttlesford as described in Part 2 of the Schedule and shown by a bold broken line on the order map numbered PROW-22-24 contained in this order.

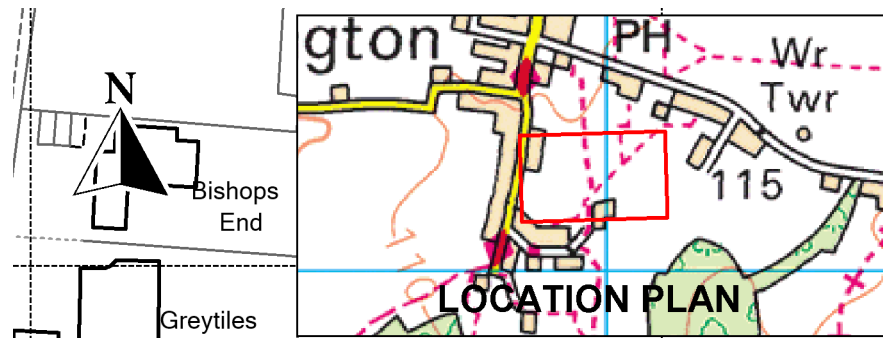

**DIVERSION OF FOOTPATH 22 WIDDINGTON
SECTION 119 HIGHWAYS ACT 1980**

Plan no. PROW-22-24

Key:

Route to Close A-B

New Route A-C

Unaffected Routes



Definitive Map Sheet TL53SW Scale 1:1200 at A4

Grid Ref at A: TL 54049 31260

Postcode at A: CB11 3SP

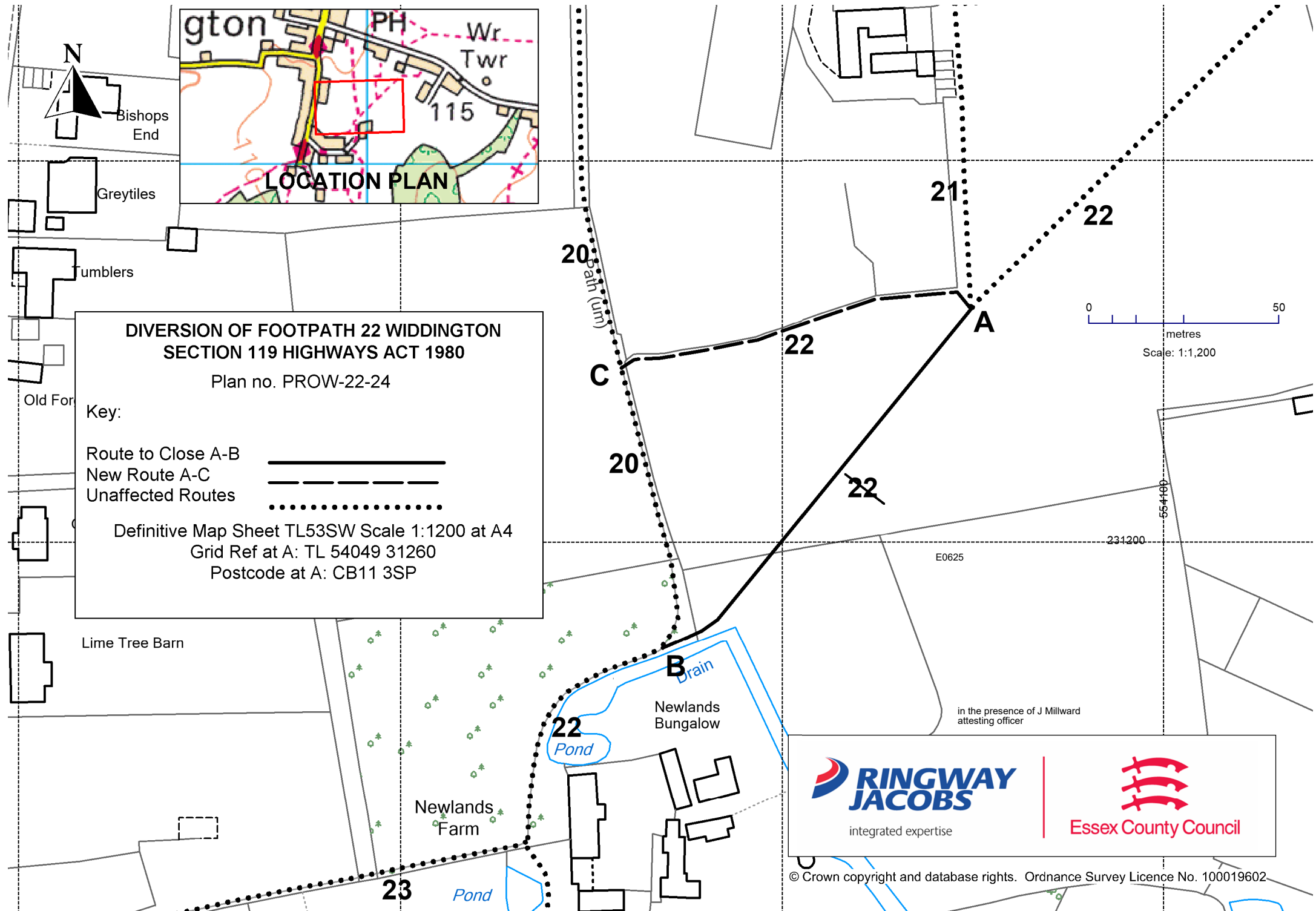

in the presence of J Millward
attesting officer

**RINGWAY
JACOBS**
integrated expertise

Essex County Council

SCHEDULE

(PART 1)

DESCRIPTION OF SITE OF EXISTING PATH OR WAY

A part length of Footpath 22 Widdington of unknown width shown by a bold continuous line on the order map commencing from point **A** at grid reference 54049,31260 at the junction with Footpath 21 Widdington running in a south westerly direction across a field and through boundary features for a total distance of approximately 121 metres to point **B** at grid reference 53968,31172 where it connects to Footpath 20 Widdington and continues unaffected.

(PART 2)

DESCRIPTION OF SITE OF NEW PATH OR WAY

A footpath being 2 metres in width shown by a bold broken line on the order map commencing at the aforementioned point **A** running in a north west then west south westerly direction across a field and then along the field edge for a total distance of approximately 96 metres to point **C** at grid reference 53958,31246 where it connects to Footpath 20 Widdington.

The COMMON SEAL of the ESSEX COUNTY COUNCIL was hereunto affixed on the Twenty First day of April 2023

E0625

In the presence of
Jacqueline Millward
Attesting Officer

Dated: 21st April 2023

PUBLIC PATH DIVERSION ORDER

**HIGHWAYS ACT 1980
SECTION 119**

Footpath 22 Widdington in the District of
Uttlesford

Paul Turner
Director, Legal and Assurance

Seax House
Victoria Road South
Chelmsford
Essex
CM1 1QH