

ESSEX COUNTY COUNCIL

PUBLIC PATH DIVERSION ORDER 2026

**FOOTPATH 45 GREENSTEAD GREEN AND HALSTEAD RURAL
AND FOOTPATH 4 COLNE ENGINE**

IN THE DISTRICT OF BRAINTREE

HIGHWAYS ACT 1980 - SECTION 119

PUBLIC PATH DIVERSION ORDER

PUBLIC PATH DIVERSION ORDER

HIGHWAYS ACT 1980 – SECTION 119

ESSEX COUNTY COUNCIL

**FOOTPATH 45 GREENSTEAD GREEN AND HALSTEAD RURAL
AND FOOTPATH 4 COLNE ENGINE**

This Order is made by Essex County Council (“the authority”) under section 119 of the Highways Act 1980 (“the 1980 Act”) because it appears to the authority that in the interest of the owner of the land crossed by the footpaths described in paragraph 1 of this order it is expedient that the line of the paths should be diverted.

The landowner has agreed to defray any compensation which becomes payable in consequence of the coming into force of this order and any expenses incurred in the order making and bringing the new site of the path into a fit condition for use by the public.

Braintree District Council have been consulted as required by section 120(2) of the 1980 Act.

BY THIS ORDER:



1) The public right of ways over the land situated south of a wooded area and dismantled railway line known as part of Footpath 45 Greenstead Green and Halstead Rural and Footpath 4 Colne Engine in the District of Braintree and shown by a bold continuous line on the order map numbered PROW-25-06 rev.21.01.26 contained in this order and described in Part 1 of the Schedule to this order shall be stopped up after 35 days from the date of confirmation of this order.

2) There shall at the end of 28 days from the date of confirmation of this order be public footpaths over land situated south of a wooded area and dismantled railway line known as part of Footpath 45 Greenstead Green and Halstead Rural and Footpath 4 Colne Engine in the District of Braintree as described in Part 2 of the Schedule and shown by a bold broken line on the order map numbered PROW-25-06 rev.21.01.26 contained in this order.

**DIVERSION OF FOOTPATH 45
GREENSTEAD GREEN & HALSTEAD RURAL
AND FOOTPATH 4 COLNE ENGINE
DISTRICT OF BRAINTREE
SECTION 119 HIGHWAYS ACT 1980**

Plan No. PROW-25-06 rev.21.01.26

Key:

Route to Close A-B-C 
New Route A-C 
Unaffected Route 

Definitive Map Sheet 82NW
Scale 1:1,500 (A3 paper)
Grid Reference at A 58296,22998
Postcode at A CO9 2EX

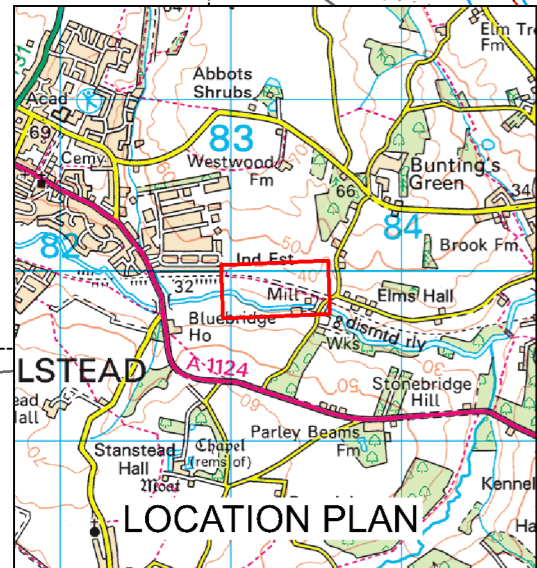
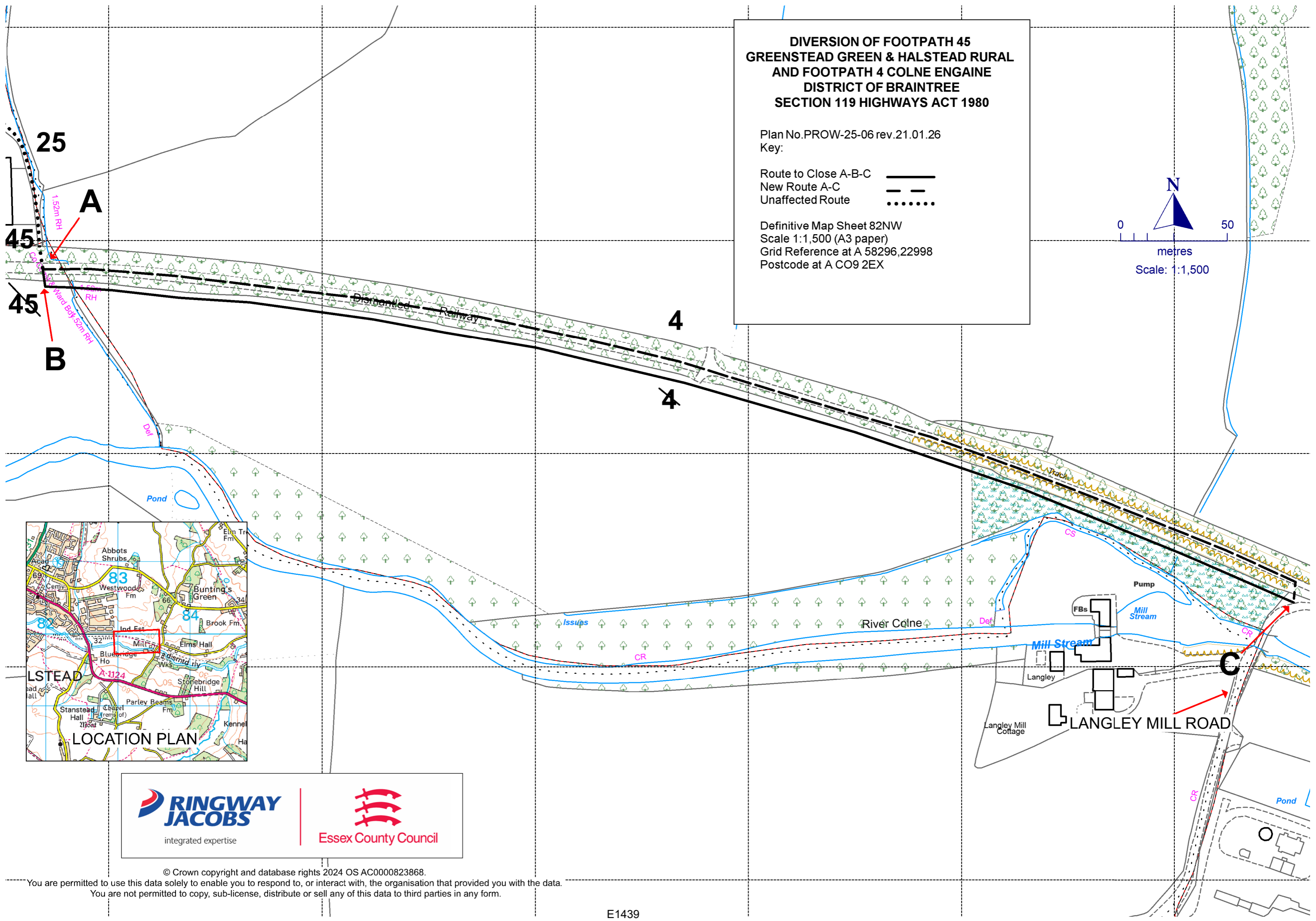
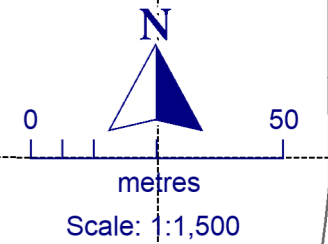

© Crown copyright and database rights 2024 OS AC0000823868.

You are permitted to use this data solely to enable you to respond to, or interact with, the organisation that provided you with the data. You are not permitted to copy, sub-license, distribute or sell any of this data to third parties in any form.

SCHEDULE

(PART 1)

DESCRIPTION OF SITE OF EXISTING PATHS OR WAYS

A part length of Footpath 45 Greenstead Green and Halstead Rural of unknown width shown by a bold continuous line on the order map commencing from point **A** at grid reference 58296,22998 located at a point on the dismantled railway line running in a generally southerly direction for a distance of approximately 8 metres to point **B** at grid reference 58297,22997 south of the dismantled railway line then running in an east south easterly direction south of and parallel to the aforementioned dismantled railway line crossing through a field boundary and parish boundary to continue as Footpath 4 Colne Engine for a final distance of approximately 606 metres to point **C** at grid reference 58355,22983 where it meets Langley Mill Road and terminates.

(PART 2)

DESCRIPTION OF SITE OF NEW PATHS OR WAYS

A footpath being 2 metres in width shown by a bold broken line on the order map commencing from the aforementioned point **A** running in an east south easterly and then generally southerly direction along the route of the dismantled railway line for a total distance of approximately 609 metres to meet the aforementioned point **C** where it terminates at Langley Mill Road.

The COMMON SEAL of ESSEX COUNTY COUNCIL was hereunto affixed on the
Twenty-ninth day of April 2026.

in the presence of



Michelle Nicoll
Attesting Officer E1439

Dated: 29th April 2026

PUBLIC PATH DIVERSION ORDER

**HIGHWAYS ACT 1980
SECTION 119**

Footpath 45 Greenstead Green and Halstead
Rural and Footpath 4 Colne Engaine
in the District of Braintree

Paul Turner
Director, Legal and Assurance

Seax House
Victoria Road South
Chelmsford
Essex
CM1 1QH