

**ESSEX COUNTY COUNCIL**

**PUBLIC PATH DIVERSION ORDER 2020  
FOOTPATH 52 SOUTH HANNINGFIELD  
IN THE CITY OF CHELMSFORD**

**HIGHWAYS ACT 1980 - SECTION 119  
PUBLIC PATH DIVERSION ORDER**

**ESSEX COUNTY COUNCIL  
HIGHWAYS ACT 1980 – SECTION 119**

**PUBLIC PATH DIVERSION ORDER**

**FOOTPATH 52 SOUTH HANNINGFIELD**

This Order is made by Essex County Council (“the authority”) under section 119 of the Highways Act 1980 (“the 1980 Act”) because it appears to the authority that in the interest of the owner of the land crossed by the footpath described in paragraph 1 of this order it is expedient that the line of the path should be diverted.

The landowner has agreed to defray any compensation which becomes payable in consequence of the coming into force of this order and any expenses incurred in the order making and bringing the new site of the path into a fit condition for use by the public.

Chelmsford City Council have been consulted and have consented to the making of the order as required by section 120(2) of the 1980 Act.



**BY THIS ORDER:**

- 1) The public right of way over the land situated south of the property ‘Bifrons’ known as Footpath 52 South Hanningfield in the City of Chelmsford and shown by a bold continuous line on the order map numbered PROW-19-37 rev.17.01.20 contained in this order and described in Part 1 of the Schedule to this order shall be stopped up after 35 days from the date of confirmation of this order
- 2) There shall at the end of 28 days from the date of confirmation of this order be a public footpath over land situated south of the property ‘Bifrons’ known as Footpath 52 South Hanningfield in the City of Chelmsford as described in Part 2 of the Schedule and shown by a bold broken line on the order map numbered PROW-19-37 rev.17.01.20 contained in this order.

**DIVERSION OF  
FOOTPATH 52 SOUTH HANNINGFIELD  
CITY OF CHELMSFORD  
SECTION 119 HIGHWAYS ACT 1980**

Plan No. PROW-19-37 rev. 17.01.20

Key:

- Route to Close A-B-C 
- New Route A-D-E-C 
- Unaffected Route 

Definitive Map Sheet TQ79NW Scale 1:500 (A3 paper)

Grid reference at A 57447, 19804

Post Code at A CM3 8HP



*Parthun*  
Attesting Officer

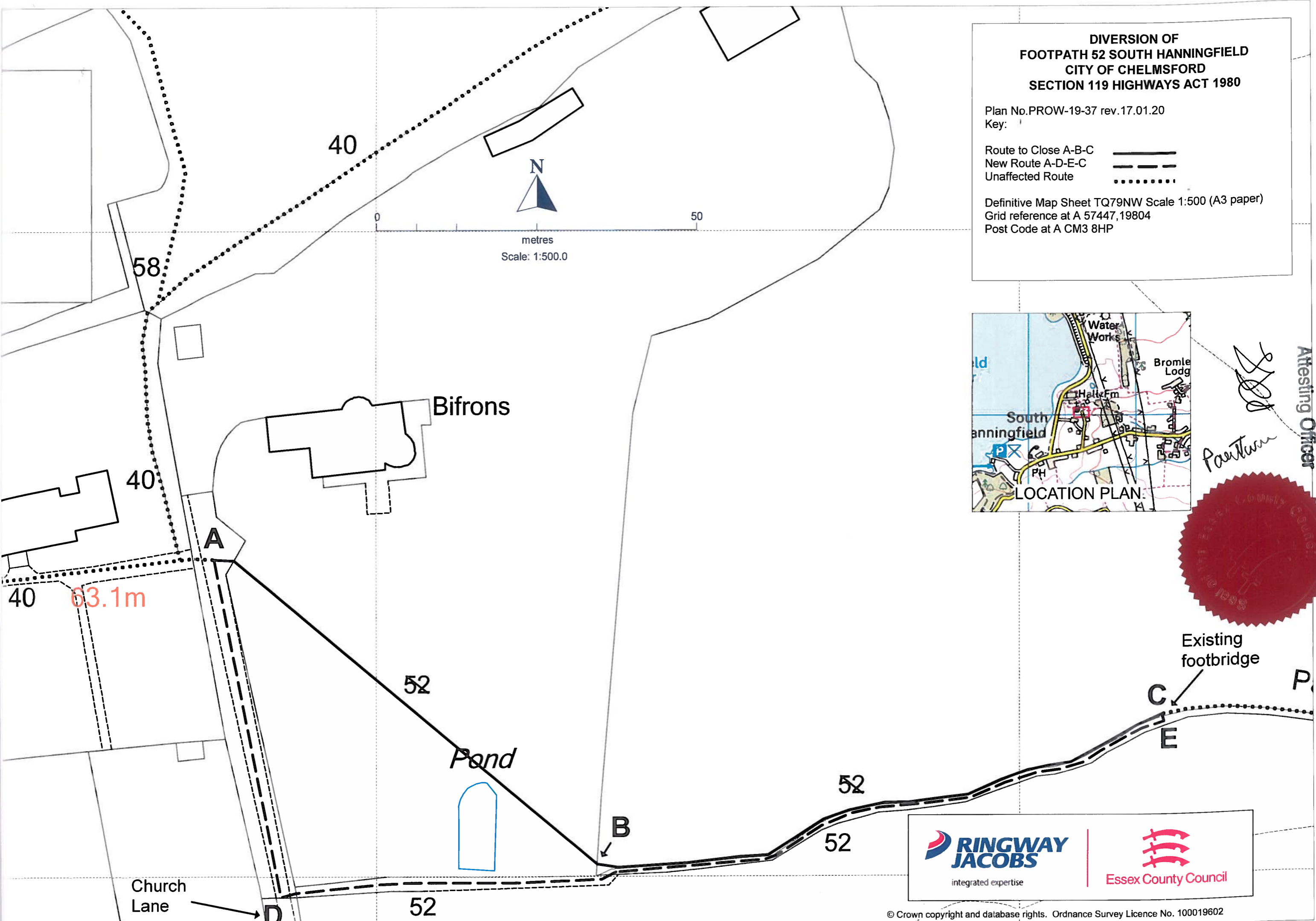

## SCHEDULE

### (PART 1)

#### DESCRIPTION OF SITE OF EXISTING PATHS OR WAYS

A part length of Footpath 52 South Hanningfield of unknown width shown by a bold continuous line on the order map commencing from point **A** at grid reference 57447,19804 approximately 5 metres east of the connection with Footpath 40 running in an easterly then south easterly direction for a distance of approximately 76 metres to point **B** at grid reference 57453,19800 on the south east corner of the property garden boundary where it continues in a generally east, north easterly direction along the field edge on the northern side of a hedge line for a distance of approximately 93 metres to point **C** at grid reference 57462,19803 where it continues unaffected

### (PART 2)

#### DESCRIPTION OF SITE OF NEW PATHS OR WAYS

A footpath being 2 metres in width shown by a bold broken line on the order map commencing at the aforementioned point **A** running in a south, south easterly direction along a property access for a distance of approximately 53 metres to point **D** at grid reference 57448,19799 where it meets the publicly maintainable highway and continues with a variable width of between 1.5 and 3 metres in first an easterly then east, north easterly direction between opposing land boundaries for a further distance of approximately 142 metres to point **E** at grid reference 57462, 19802 where it runs briefly in a northerly direction for a final distance of approximately 1 metre to cross the boundary and connect to the aforementioned point **C**

Given under the Common Seal of Essex County Council this *Twenty first* day  
of *February* 2020

The common seal of **ESSEX** )  
**COUNTY COUNCIL** was here- )  
unto affixed in the presence of: )



40694

Attesting Officer:

JOANNA CENT.

Dated: 21<sup>st</sup> day of February 2020

**PUBLIC PATH DIVERSION ORDER**

**HIGHWAYS ACT 1980  
SECTION 119**

Footpath 52 in the parish of South  
Hanningfield in the City of Chelmsford

Paul Turner  
Director, Legal and Assurance

Seax House  
Victoria Road South  
Chelmsford  
Essex  
CM1 1QH

**CONFIRMATION ORDER**

**PUBLIC PATH DIVERSION ORDER 2020**

**FOOTPATH 52 SOUTH HANNINGFIELD**

**IN THE CITY OF CHELMSFORD**

**ESSEX COUNTY COUNCIL** in exercise of the powers conferred upon it in that behalf, hereby confirm the foregoing Order:

THIS ORDER IS HEREBY CONFIRMED AS UNOPPOSED ORDER

The common seal of **ESSEX** )  
**COUNTY COUNCIL** was hereunto )  
affixed on *Third June* 2020)  
in the presence of:-

*Paul Turner*  
Attesting Officer:



40886

Dated: 3<sup>rd</sup> day of June 2020 -

**PUBLIC PATH DIVERSION ORDER**

**HIGHWAYS ACT 1980  
SECTION 119**

Footpath 52 in the parish of South  
Hanningfield in the City of Chelmsford

Paul Turner  
Director, Legal and Assurance

Seax House  
Victoria Road South  
Chelmsford  
Essex CM1 1QH