

ESSEX COUNTY COUNCIL

PUBLIC PATH DIVERSION ORDER 2020

FOOTPATH 4 KELVEDON

IN THE DISTRICT OF BRAINTREE

HIGHWAYS ACT 1980 - SECTION 119

PUBLIC PATH DIVERSION ORDER

PUBLIC PATH DIVERSION ORDER
HIGHWAYS ACT 1980 – SECTION 119
ESSEX COUNTY COUNCIL
FOOTPATH 4 BRAINTREE

This Order is made by Essex County Council (“the authority”) under section 119 of the Highways Act 1980 (“the 1980 Act”) because it appears to the authority that in the interest of the owner of the land crossed by the footpath described in paragraph 1 of this order it is expedient that the line of the path should be diverted.

The landowner has agreed to defray any compensation which becomes payable in consequence of the coming into force of this order and any expenses incurred in the order making and bringing the new site of the path into a fit condition for use by the public.

Braintree District Council have been consulted and have consented to the making of the order as required by section 120(2) of the 1980 Act.

BY THIS ORDER:

- 1) The public right of way over the land situated east of Coggeshall Road known as Footpath 4 Kelvedon in the District of Braintree and shown by a bold continuous line on the order map numbered PROW-20-09 rev.02.03.20 contained in this order and described in Part 1 of the Schedule to this order shall be stopped up after 35 days from the date of confirmation of this order.

- 2) There shall at the end of 28 days from the date of confirmation of this order be a public footpath over land situated at east of Coggeshall Road known as Footpath 4 Kelvedon in the District of Braintree as described in Part 2 of the Schedule and shown by a bold broken line on the order map numbered PROW-20-09 rev.02.03.20 contained in this order.



**DIVERSION OF FOOTPATH 4 KELVEDON
DISTRICT OF BRAINTREE
SECTION 119 HIGHWAYS ACT 1980**
Plan No. PROW-20-09 rev.02.03.20
Key:
Route to Close A-B ———
New Route A-C-B - - -
Unaffected Route
Definitive Map Sheet TL81NE
Scale 1:1,500 (A4 paper)
Grid Reference at A 58633,21961
Post Code at A CO5 9PE

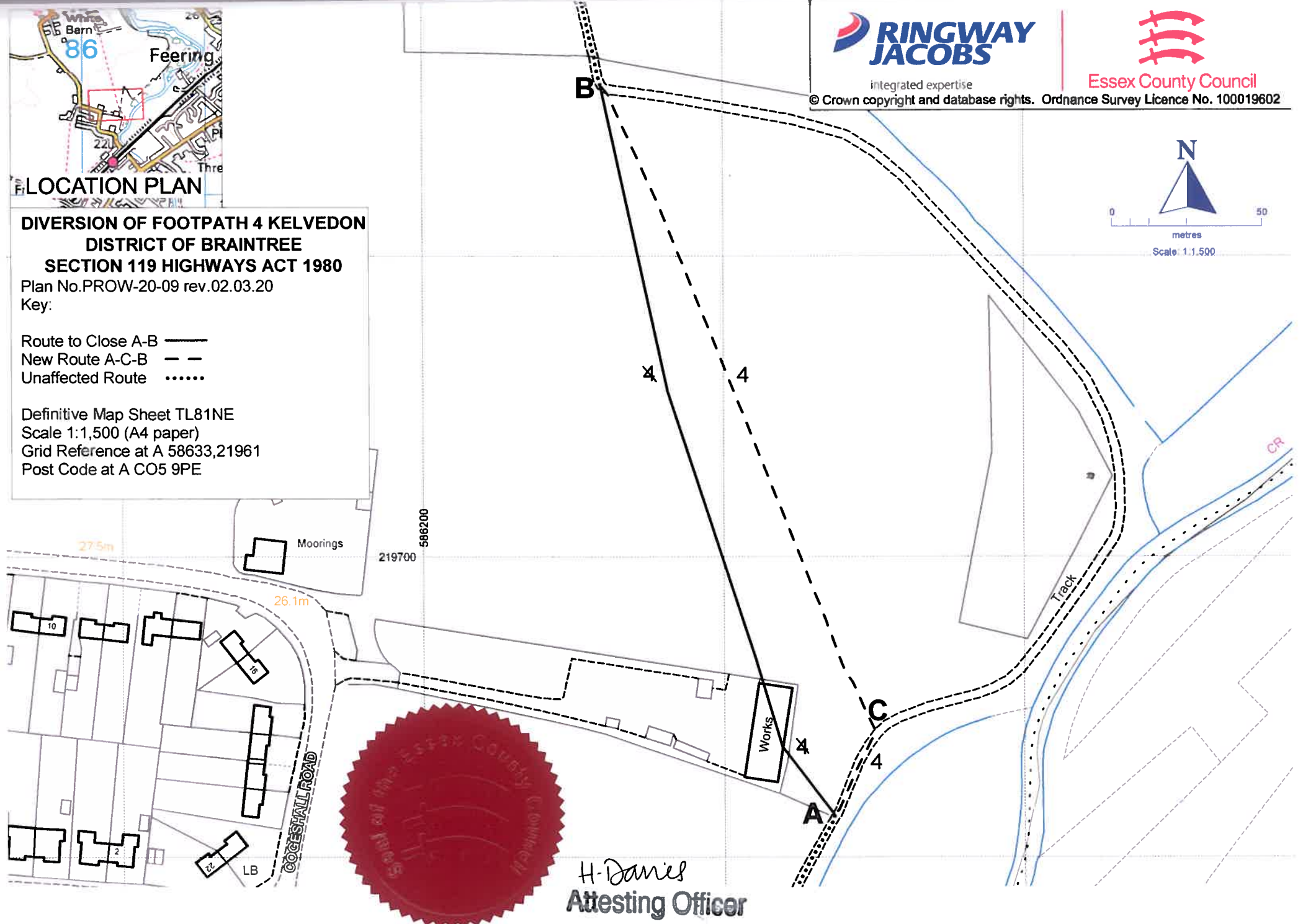
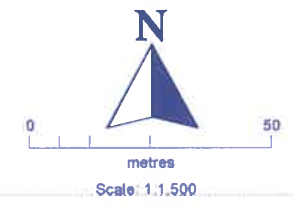

H. Daniel
Attesting Officer

SCHEDULE

(PART 1)

DESCRIPTION OF SITE OF EXISTING PATH OR WAY

A part length of Footpath 4 Kelvedon of unknown width shown by a bold continuous line on the order map commencing from point **A** at grid reference 58633,21961 at a field boundary running in first a north westerly then north north westerly direction across an area of scrub vegetation through a building then continuing across a field for a total distance of approximately 256 metres to point **B** at grid reference 59625,21985 at the field edge where the path continues unaffected.

(PART 2)

DESCRIPTION OF SITE OF NEW PATH OR WAY

A footpath being 2 metres in width shown by a bold broken line on the order map commencing at the aforementioned point **A** running in a north north easterly direction across an area of scrub vegetation for a distance of approximately 31 metres to point **C** at grid reference 58635,21964 then in a north north westerly direction at a width of 1 metre across a field for a final distance of approximately 233 metres to the aforementioned point **B**.

Given under the Common Seal of Essex County Council this _____ day
of *Eighth day of July 2020*

The common seal of **ESSEX**)
COUNTY COUNCIL was here-)
unto affixed in the presence of:)

H. Daniel
Attesting Officer:



40959

Dated: 8th day of July 2020

PUBLIC PATH DIVERSION ORDER

**HIGHWAYS ACT 1980
SECTION 119**

Footpath 4 in the parish of Kelvedon in the
District of Braintree

Paul Turner
Director, Legal and Assurance

Seax House
Victoria Road South
Chelmsford
Essex
CM1 1QH