

ESSEX COUNTY COUNCIL

PUBLIC PATH DIVERSION ORDER 2020

FOOTPATH 4 KELVEDON

IN THE DISTRICT OF BRAINTREE

HIGHWAYS ACT 1980 - SECTION 119

PUBLIC PATH DIVERSION ORDER

PUBLIC PATH DIVERSION ORDER
HIGHWAYS ACT 1980 – SECTION 119
ESSEX COUNTY COUNCIL
FOOTPATH 4 BRAINTREE

This Order is made by Essex County Council (“the authority”) under section 119 of the Highways Act 1980 (“the 1980 Act”) because it appears to the authority that in the interest of the owner of the land crossed by the footpath described in paragraph 1 of this order it is expedient that the line of the path should be diverted.

The landowner has agreed to defray any compensation which becomes payable in consequence of the coming into force of this order and any expenses incurred in the order making and bringing the new site of the path into a fit condition for use by the public.

Braintree District Council have been consulted and have consented to the making of the order as required by section 120(2) of the 1980 Act.

BY THIS ORDER:

- 1) The public right of way over the land situated east of Coggeshall Road known as Footpath 4 Kelvedon in the District of Braintree and shown by a bold continuous line on the order map numbered PROW-20-09 rev.02.03.20 contained in this order and described in Part 1 of the Schedule to this order shall be stopped up after 35 days from the date of confirmation of this order.

- 2) There shall at the end of 28 days from the date of confirmation of this order be a public footpath over land situated at east of Coggeshall Road known as Footpath 4 Kelvedon in the District of Braintree as described in Part 2 of the Schedule and shown by a bold broken line on the order map numbered PROW-20-09 rev.02.03.20 contained in this order.



LOCATION PLAN

**DIVERSION OF FOOTPATH 4 KELVEDON
DISTRICT OF BRAINTREE
SECTION 119 HIGHWAYS ACT 1980**

Plan No. PROW-20-09 rev.02.03.20
Key:

- Route to Close A-B ———
- New Route A-C-B - - -
- Unaffected Route

Definitive Map Sheet TL81NE
Scale 1:1,500 (A4 paper)
Grid Reference at A 58633,21961
Post Code at A CO5 9PE



integrated expertise
© Crown copyright and database rights. Ordnance Survey Licence No. 100019602



Essex County Council

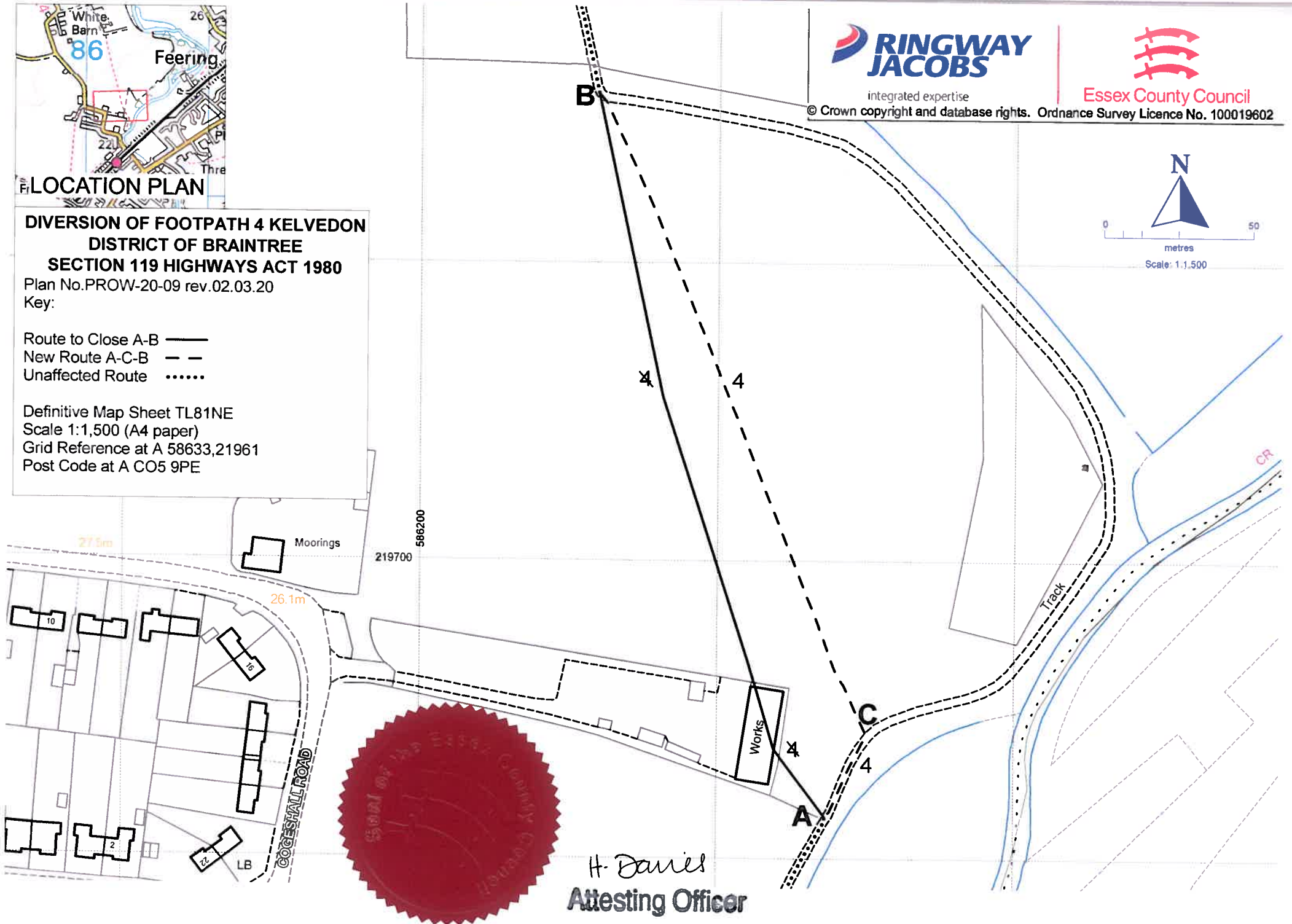
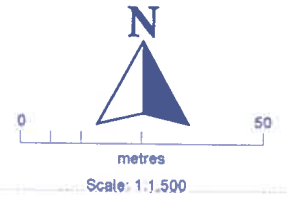

H. Daniel
Attesting Officer

SCHEDULE

(PART 1)

DESCRIPTION OF SITE OF EXISTING PATH OR WAY

A part length of Footpath 4 Kelvedon of unknown width shown by a bold continuous line on the order map commencing from point **A** at grid reference 58633,21961 at a field boundary running in first a north westerly then north north westerly direction across an area of scrub vegetation through a building then continuing across a field for a total distance of approximately 256 metres to point **B** at grid reference 59625,21985 at the field edge where the path continues unaffected.

(PART 2)

DESCRIPTION OF SITE OF NEW PATH OR WAY

A footpath being 2 metres in width shown by a bold broken line on the order map commencing at the aforementioned point **A** running in a north north easterly direction across an area of scrub vegetation for a distance of approximately 31 metres to point **C** at grid reference 58635,21964 then in a north north westerly direction at a width of 1 metre across a field for a final distance of approximately 233 metres to the aforementioned point **B**.

Given under the Common Seal of Essex County Council this _____ day
of *Eight day of July* 2020

The common seal of **ESSEX**)
COUNTY COUNCIL was here-)
unto affixed in the presence of:)



40959

H. Daniels

Attesting Officer:

8th
~~Eight day~~

HIGHWAYS ACT 1980 – SECTION 119

PUBLIC PATH DIVERSION ORDER 2020

FOOTPATH 4 KELVEDON

IN THE DISTRICT OF BRAINTREE

ESSEX COUNTY COUNCIL in exercise of the powers conferred upon them in that behalf, hereby confirm the foregoing Order:

THIS ORDER IS HEREBY CONFIRMED AS UNOPPOSED ORDER

The common seal of **ESSEX COUNTY**)
COUNCIL was hereunto affixed on the)
 Seventh day of *October* 2020)
in the presence of:-)



Attesting Officer: *J Edwards*

41200

Dated: 4th day of October 2020

CONFIRMATION ORDER

PUBLIC PATH DIVERSION ORDER

**HIGHWAYS ACT 1980
SECTION 119**

Footpath 4 in the Parish of Kelvedon in the
District of Braintree

PAUL TURNER
Director, Legal and Assurance

Essex County Council
Seax House
Victoria Road South
Chelmsford
Essex
CM1 1QH

HIGH/11661 (KAS)