

**ESSEX COUNTY COUNCIL**

**PUBLIC PATH DIVERSION ORDER 2020**

**BRIDLEWAY 47 AND FOOTPATH 57 HERONGATE AND INGRAVE**

**IN THE BOROUGH OF BRENTWOOD**

**HIGHWAYS ACT 1980 - SECTION 119**

**PUBLIC PATH DIVERSION ORDER**

**PUBLIC PATH DIVERSION ORDER**  
**HIGHWAYS ACT 1980 – SECTION 119**  
**ESSEX COUNTY COUNCIL**

**BRIDLEWAY 47 AND FOOTPATH 57 HERONGATE AND INGRAVE**

This Order is made by Essex County Council (“the authority”) under section 119 of the Highways Act 1980 (“the 1980 Act”) because it appears to the authority that in the interest of the owner of the land crossed by the bridleway and footpath described in paragraph 1 of this order it is expedient that the line of the way and path should be diverted.

The landowner has agreed to defray any compensation which becomes payable in consequence of the coming into force of this order and any expenses incurred in the order making and bringing the new site of the paths into a fit condition for use by the public.

Brentwood Borough Council have been consulted and have consented to the making of the order as required by section 120(2) of the 1980 Act.

**BY THIS ORDER:**

- 1) The public rights of way over the land situated south of Heron Hall known as Bridleway 47 and Footpath 57 Herongate and Ingrave in the Borough of Brentwood and shown by bold continuous lines on the order map numbered PROW-20-05 rev.30.06.20 contained in this order and described in Part 1 of the Schedule to this order shall be stopped up after 60 days from the date of confirmation of this order.
- 2) There shall at the end of 60 days from the date of confirmation of this order be a public bridleway and footpath over land situated south of Heron Hall known as Bridleway 47 and Footpath 57 Herongate and Ingrave in the Borough of Brentwood as described in Part 2 of the Schedule and shown by bold broken lines on the order map numbered PROW-20-05 rev.30.06.20 contained in this order.

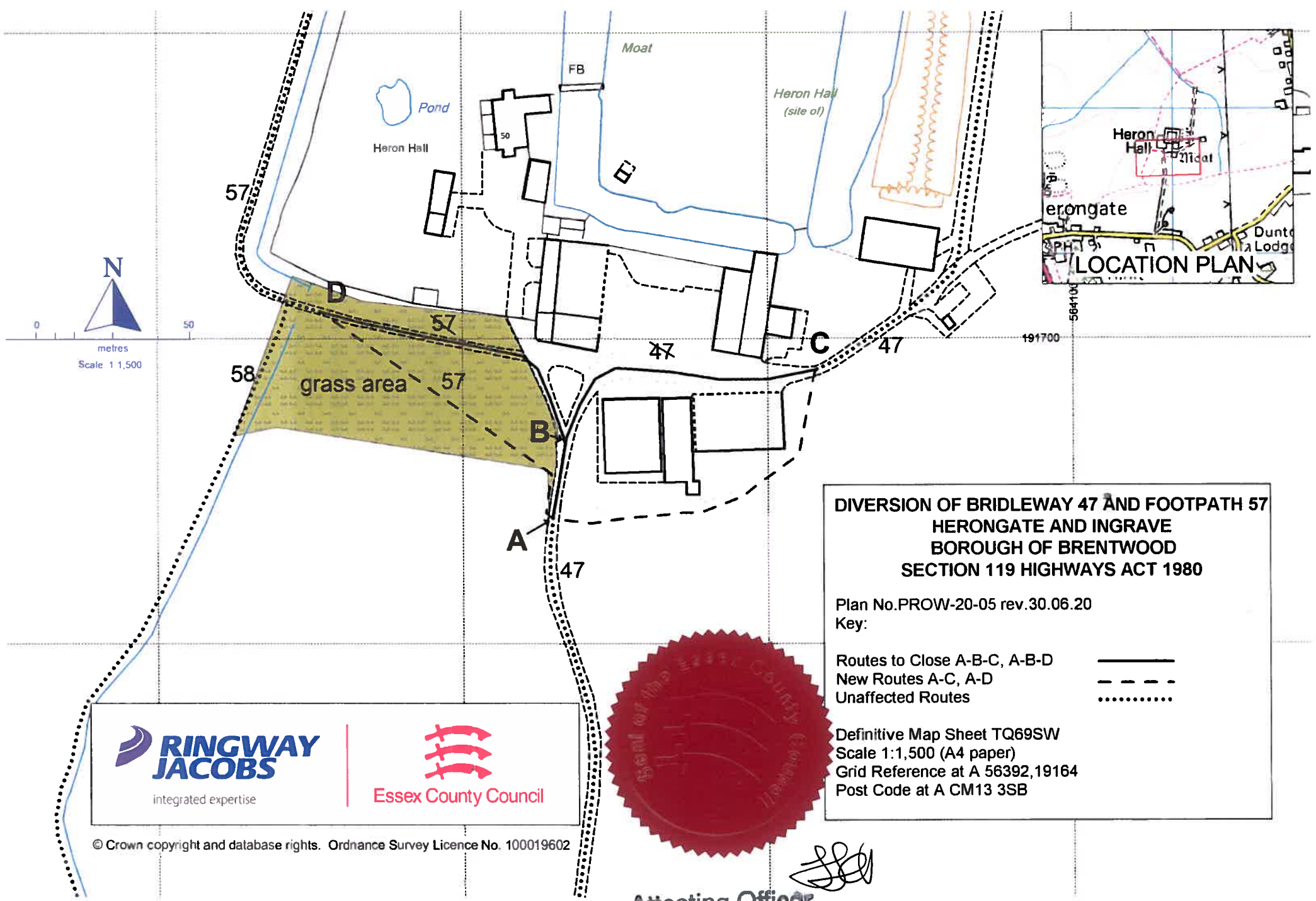

**DIVERSION OF BRIDLEWAY 47 AND FOOTPATH 57  
HERONGATE AND INGRAVE  
BOROUGH OF BRENTWOOD  
SECTION 119 HIGHWAYS ACT 1980**

Plan No. PROW-20-05 rev.30.06.20  
Key:

Routes to Close A-B-C, A-B-D	—————
New Routes A-C, A-D	- - - - -
Unaffected Routes	.....

Definitive Map Sheet TQ69SW  
Scale 1:1,500 (A4 paper)  
Grid Reference at A 56392,19164  
Post Code at A CM13 3SB



integrated expertise



Essex County Council



**Attesting Officer**

## SCHEDULE

### (PART 1)

#### DESCRIPTION OF SITE OF EXISTING PATHS OR WAYS

##### Bridleway 47

A part length of Bridleway 47 Herongate and Ingrave being 2.5 metres in width shown by a bold continuous black line on the order map commencing from point **A** at grid reference 56392,19164 on the access drive to heron Hall running in a generally northerly direction along the access drive for a distance of approximately 27 metres to point **B** at grid reference 56393, 19166 at its junction with Footpath 57 Herongate and Ingrave then continuing in a generally northerly then generally easterly direction along the access drive for a final distance of approximately 95 metres to point **C** at grid reference 56401,19168 where it continues unaffected.

##### Footpath 57

A part length of Footpath 57 Herongate and Ingrave being of 1.25 metres in width shown by a bold continuous black line on the order map commencing from the aforementioned point **B** at its junction with Bridleway 47 running in a north north-westerly then a west north-westerly direction for a total distance of approximately 99 metres along the access drive to point **D** at grid reference 56385,19170 where it continues unaffected.

### (PART 2)

#### DESCRIPTION OF SITE OF NEW PATHS OR WAYS

##### Bridleway 47

A bridleway being 3 metres in width shown by a bold broken black line on the order map commencing at the aforementioned point **A** running in an east north-easterly then a north easterly then continuing in a north north-easterly direction for a total distance of approximately 114 metres to the aforementioned point **C** at the field edge where it continues unaffected.

Footpath 57

A footpath being 2 metres in width shown by a bold broken black line on the order map commencing at the aforementioned point **A** running in first a generally northerly then north westerly direction for a distance of approximately 107 metres across a grass area to the aforementioned point **D** where it continues unaffected.

Given under the Common Seal of Essex County Council this 8 day  
of July 2020

The common seal of **ESSEX** )  
**COUNTY COUNCIL** was here- )  
unto affixed in the presence of: )



Attesting Officer: *[Signature]* (JOANNA GENT)

40960

Dated: 8<sup>r</sup> day of July 2020

**PUBLIC PATH DIVERSION ORDER**

**HIGHWAYS ACT 1980  
SECTION 119**

Bridleway 47 and Footpath 57 in the parish  
of Herongate and Ingrave in the Borough of  
Brentwood

Paul Turner  
Director, Legal and Assurance

Seax House  
Victoria Road South  
Chelmsford  
Essex  
CM1 1QH