

NOTES

- All traffic signs shall comply with Chapter 8 of the Traffic Signs Manual
- All traffic management equipment shall be provided by the Contractor, unless otherwise specified
- All signs shall be positioned so as not to be obscured by any other objects and shall not obstruct any other signs, pavement or temporary or permanent road markings
- All traffic signs shall meet the reflectance requirements of BS 673: Part 6: 1983, Table 1.
- Works Access/Egress to be positioned to suit ongoing works.

KEY

- Cone
- Sign
- Work area
- Marshall
- Diversion Route
- Pedestrian Barrier
- Pedestrian ramp (Fixed to ground)

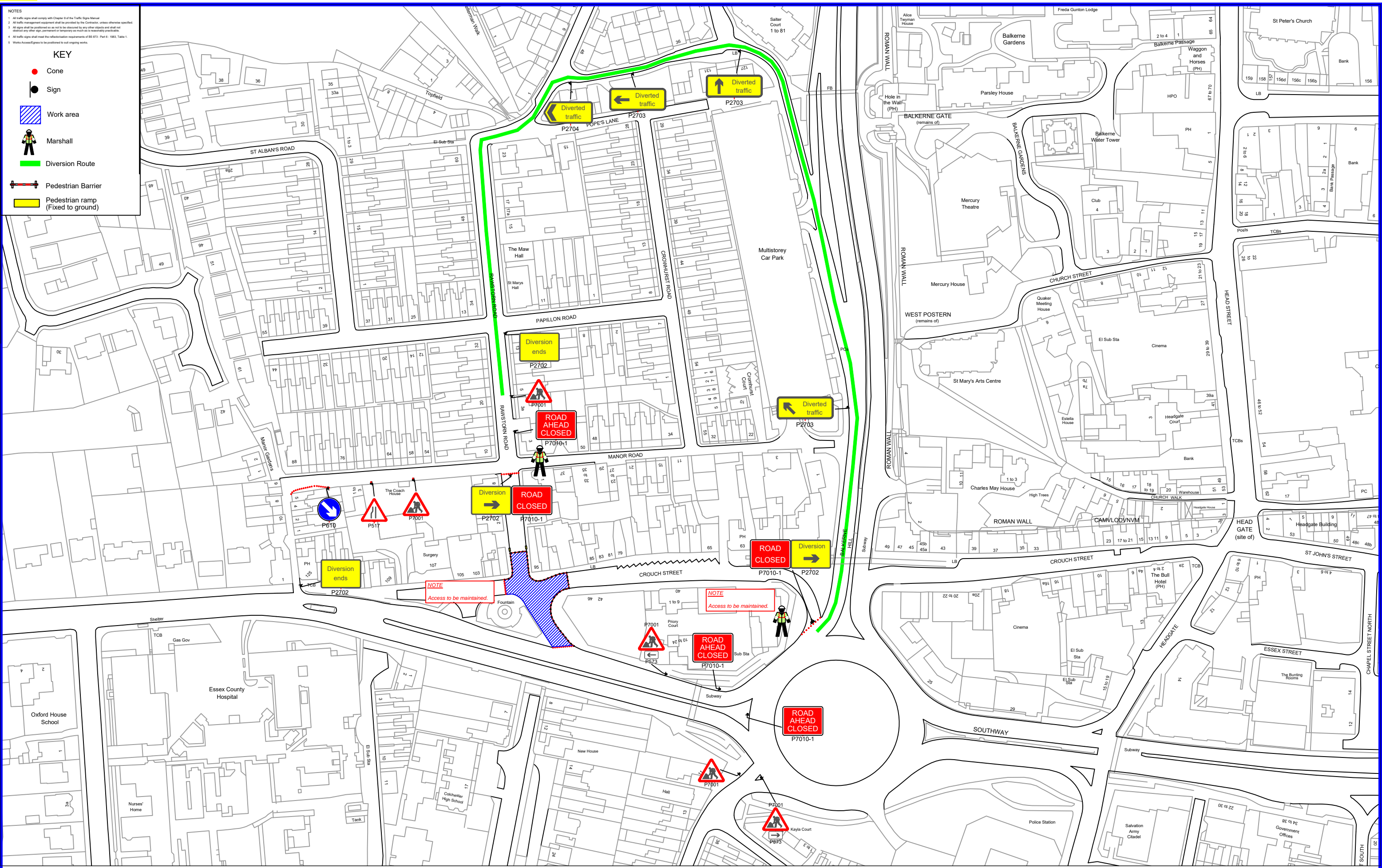

Unit 6, Codham Hall Farm
 Great Warley
 Brentwood, Essex CM13 3FB
 Telephone 01277 227866
 Email Enquiries@triplextm.co.uk

A	Various changes	SJ	SJ
Rev	Amendments	Chkd	Appd

Scale
 Not to Scale
 Drawn by
 MD

Date
 08/11/17
 Checked
 SJ

Title
 Crouch Street, Colchester - Road Closure & Diversion
 Drawing / Job Ref.
 7286.001