

Option 2

Land acquisition on western side from properties to construct a 2.5m shared cycle path and Toucan crossing.

This option requires land acquisition on the western side of Colchester Road to widen the existing footway.

Estimated cost: £250,000, depending on land costs.

Considerations:

- Passing traffic
- Limited street lighting
- Value for money
- Private property land acquisition required (potentially via CPO)
- On-coming traffic at night
- Shared surface (2.5m) for cyclists and pedestrians

Plot 3
Total Area = 255.74m²
(Continues on drawing DC188-100-005)

Notes

1. Specification for Pedestrian/Cycleway:
30mm DBM Surface Course
50mm Base Course
150mm Type 1 Sub Base
Geotextile Terram 1000 (or equivalent)

Key

- Existing Highway Boundary
- █ Land Acquisition Required
- ▨ Proposed foot/cycleway

REV.	DATE	AMENDMENT DESCRIPTION	DRAWN	CHECKED
A	XXX 12	DESCRIPTION	XX	XX

DRAWING STATUS
DRAFT



Ringway Jacobs working in partnership with Essex County Council

Paul Bird, Director for Highways & Transportation
County Hall, Chelmsford, CM1 1QH
Tel: 0845 6037631
© Essex County Council

SCHEME TITLE
**University to Wivenhoe
Cycling & Walking Route**

DRAWING TITLE
**2.5m Width Foot/Cycleway
Sheet 3 of 3**

SURVEYED	DESIGNED	DRAWN	CHECKED	AUTHORISED
XX	XX	SW	XX	XX
DATE	DATE	DATE	DATE	DATE
XXX 13	XXX 13	JUNE 13	XXX 13	XXX 13

DRAWING UNITS: U.N.O.
DIMENSIONS IN METRES
LEVELS IN METRES

SCALE: AT A1 (841x594mm)
1:500

DRAWING No. **DC188-100-006** REV. -

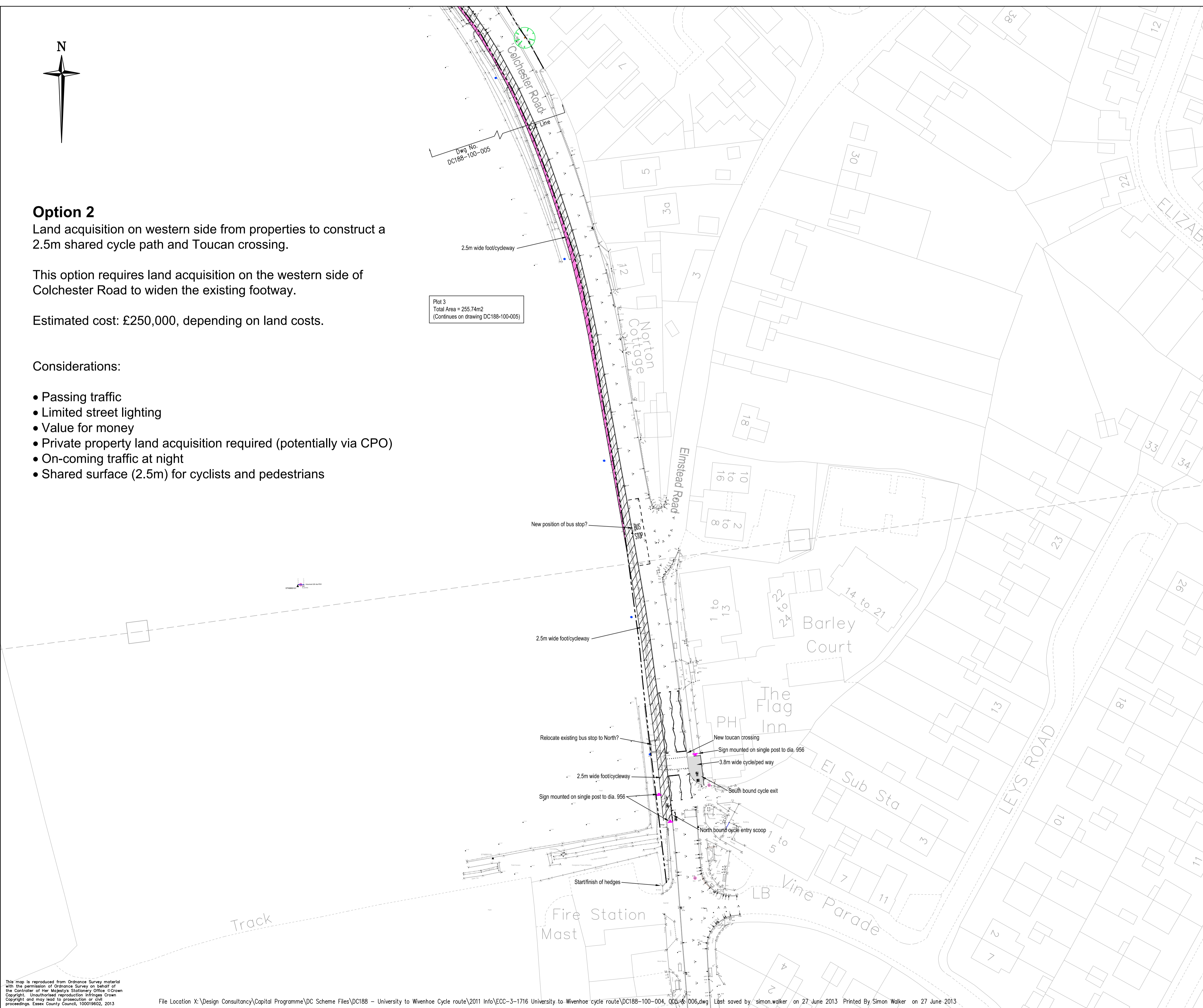

This map is reproduced from Ordnance Survey material with the permission of Ordnance Survey on behalf of the Controller of Her Majesty's Stationery Office. Copyright. Unauthorised reproduction infringes Crown Copyright and may lead to prosecution or civil proceedings. Essex County Council, 100019602, 2013