



Option 1

Full re-alignment of existing carriageway to construct a 3m wide shared cycle path and Toucan crossing.

This option requires land acquisition on the eastern side of Colchester Road to move the carriageway to accommodate the cycle path on the western footway.

Estimated cost: £600,000 to £750,000, depending on land costs.

Considerations:

- Full width (3m) cycleway
- No private property land acquisition
- Passing traffic
- Limited street lighting
- On-coming traffic at night
- Cost
- Value for money

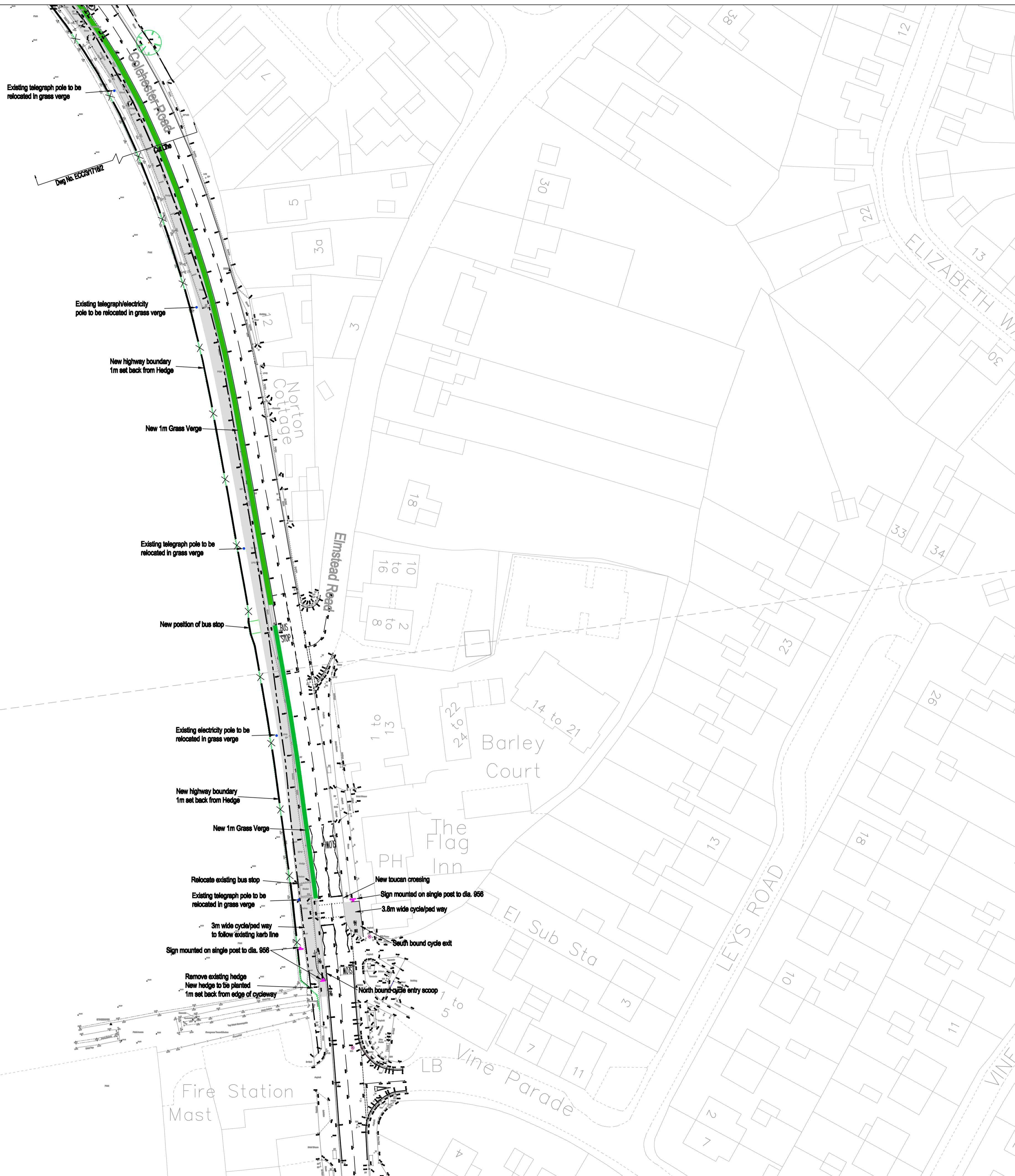

Notes

1. Specification for Pedestrian/Cycleway
25mm DBM Surface Course
60mm Base Course
150mm Type 1 Sub Base
2. Spec for Carriageway Lb.c.
3. New gate details as follows:
2no. 12ft minimum 5 bar metal gates to 24ft opening
Specification to Highway Construction Details Drawing No. H20

Key

- Existing Highway Boundary
- x-x-x- New Highway Boundary
- New Hedge Line
- New Pedestrian/Cycle Route
- Resigned Carriageway
- Resigned Ditch
- New Grass Verge

A Updated to answer Engineering Detail queries

Rev	Amendments	Chkd	Appd

Essex County Council
Highways & Transportation Group

PAUL BIRD
DIRECTOR FOR DEVELOPMENT HIGHWAYS AND TRANSPORTATION
EAST AREA OFFICE
910 THE CRESCENT
COLCHESTER CO4 9QQ
Telephone: 01206 838600

Project
**University to Wivenhoe
Cycling & Walking Route**

Scale
1:500 @ A1 Date
June 11

Drawing
**Design Proposal
Sheet 3 of 3**

Drawn by RJL	Checked TJ	Issue Auth. BG
-----------------	---------------	-------------------

Drawing Number
ECC/3/1716/3